

Final Program

Growth, Conservation and Responsibility

Promoting Good Governance and
Corporate Stewardship through Impact Assessment

27th Annual Conference

International Association for Impact Assessment

3-9 June 2007

COEX Convention Center
Seoul, Korea



Table of Contents

TABLE OF CONTENTS

Welcome to IAIA07	3
Special Events	4
Conference Theme	5
Keynote Speakers	6
Program Overview	8
Daily Schedule	10
Technical Program Overview	12
Theme Forums	14
Concurrent Sessions	18
Posters	28
Exhibitors	30
Map: City of Seoul	30
Technical Visits	31
Sections	32
IAIA Business	33
Tips & Information	34
General Information	35
Committees	36
Map: COEX	38
Sponsors	40

CONFERENCE VENUE

COEX Convention Center
 159 Samsung-dong, Gangnam-gu
 Seoul, 135-731 Korea
 Phone +82 2 6000 1125
 Fax +82 2 6000 1303
 marketing1@coex.co.kr
 www.coex.co.kr

IAIA07 At-A-Glance

Saturday, 2 June

Registration Afternoon

Sunday, 3 June

Training Courses, Technical Visit All Day/Afternoon

Monday, 4 June

Training Courses All Day

Korea's Demilitarized Zone (DMZ) Conservation All Day

HIA-SIA Workshop All Day

Technical Visits All Day

Opening Reception Evening

Tuesday, 5 June

Committee Meeting Morning

Plenary, Theme Forums, Poster Session, Concurrent Sessions All Day

Practitioners' Forums Afternoon

Special Dinner Evening

Wednesday, 6 June

Fun Run Early Morning

Committee Meetings Morning

Theme Forums, AGM, Concurrent Sessions All Day

Practitioners' Forums Afternoon

Dine Out Seoul Evening

Thursday, 7 June

Section Meetings Morning

Theme Forums, Council Meeting, Concurrent Sessions All Day

Practitioners' Forums Afternoon

Banquet Evening

Friday, 8 June

Awards, Closing Plenary Morning

Technical Visit Afternoon

Welcome to IAIA07

Welcome to IAIA07!

On behalf of the Program Committee, we warmly welcome you to the 27th annual conference of the International Association for Impact Assessment (IAIA). For years, the conference has provided delegates from around the world with an excellent venue to value, share, debate, discuss, and disseminate their knowledge, expertise and ideas. This year promises to be no exception.

You will fully benefit from the insights of eminent keynote speakers and from participating in Theme Forums that address challenging and cross-cutting topics. Many concurrent sessions will improve understanding of your interested fields. In addition, a special pre-conference meeting, "Korea's Demilitarized Zone (DMZ) Conservation: Science and Impact Assessment," and a Theme Forum and topical stream on "Impact Assessment in Asia" will illuminate regional specificity. Theme Forums such as Corporate Stewardship, Capacity Building, Governance, Biodiversity and Sustainability, and Sustainable Development will offer opportunities to think about "Growth, Conservation, and Responsibility" for sustainable society. Concurrent sessions will represent a broad spectrum of topics such as Public Participation, Corporate Stewardship, SIA, Environmental Management Systems, SEA, HIA, Biodiversity, Sustainable Development, IA Law, Policies and Practice, EIA Methodologies, Land Use Planning and so on. In addition, first-rate training courses will open ample opportunities for delegates to learn from renowned experts.

IAIA07 is thus a multi-faceted conference that gives you rich opportunities to compose your own conference, by choosing topical streams to suit your professional needs and interests. The technical program and room arrangements are organized according to topical streams to help you find your topics with ease.

The conference takes place in Seoul where something exciting happens every day. We certainly expect that you will be treated with great memories and utmost hospitality. Dine-Out will take you to pleasant cuisine and scenery in downtown Seoul. Technical visits will explore the issues of development, conservation, restoration, and sustainability by examining a stream restoration project, ecologically restored former landfill sites, and an urban redevelopment project. Special tours and events such as the Fun Run were arranged to explore the City of Seoul where tradition and the future mingle together.

The program committee welcomes your passionate participation. We urge you to peruse the program and to take advantage of the opportunities that are open to you. Learning, sharing, and just talking with your professional colleagues beyond boundaries, we certainly hope that you will have an unforgettable conference experience and, above all, fun.

Welcome!

Suh Sung Yoon

IAIA07 Program Committee Chair

Welcome and Introduction to IAIA07

Welcome to Seoul and Korea, as we gather together for this, the IAIA's 27th annual conference.

Our hosts have worked hard to devise a varied and thorough programme on the theme of Promoting Good Governance and Corporate Stewardship through Impact Assessment. Your presence here and support in addressing this topic is highly encouraging. Governance and stewardship are important areas for debate and discussion, as we are increasingly caught between two interpenetrating worlds—the 4 billion year old Living World and the 5,000 year old World of Man. Unsustainability results from a lack of integration between them. Reintegrating sustainability through conservation, regeneration and stewardship is now not only a major challenge but a priority.

One of the most important functions of IAIA meetings is the opportunity they afford for IA professionals from diverse parts of the world to take an active part in the programme, enter into the debates and to bring their unique perspective and experience to issues. One of the lasting legacies of all our conferences are the friends and contacts we make during our brief week together. So network widely and make new friendships. It is through these contacts that we increasingly address the complex issues we face.

Dr. Suh-Sung Yoon and his colleagues have done a fantastic job pulling together this conference. I am sure their efforts, together with your energetic participation, will make for a fulfilling and uplifting meeting.

Most sincerely,

Ross Marshall

*President, International Association for Impact Assessment
Manager, NEAS, Environment Agency, UK*

Special Events

Special Pre-Conference Meeting

Korea's Demilitarized Zone (DMZ) Conservation: Science and Impact Assessment

Undisturbed for 50 years, the Korean DMZ is an important refuge for many species of wildlife, including two of the world's most endangered birds (the white-naped and red-crowned crane). The DMZ is also home to Asiatic black bears, Chinese goral and egrets, and some claim even the Korean tiger, a subspecies of the Siberian tiger, one of the rarest tigers in the world. Environmental scientists have a unique opportunity in the DMZ to study how nature restored itself after the area was devastated by war.

This special meeting brings together scientists and professionals from diverse scientific disciplines, including the impact assessment community interested in conservation of transboundary ecosystems for an exchange of ideas, science and technology necessary to build and manage sustainable protected areas in the DMZ corridor and adjacent ecosystems on the Korean peninsula. Although the discussions will focus on the DMZ, lessons learned may be applicable to other areas attempting to provide conservation reserves.

Highly acclaimed experts set the stage in the opening plenary for an exchange of ideas by discussing inclusion of biodiversity in impact assessment, Korea's environment and sustainable future, the preservation of Korea's DMZ corridor for conservation, the wild and vibrant world of the DMZ ecosystems, and peace parks for transboundary ecosystems. The afternoon is devoted to presentation of submitted papers and a wrap-up session synthesizing the day's discussions and implications for future activities.

Co-Conveners: **Ke Chung Kim**, Professor and Director, Center for Biodiversity Research, and Chair, Institute of the Environment, Pennsylvania State University, USA, and **Hoi-Seong Jeong**, President, KEI, Korea.

Organizing Institutions: The DMZ Forum and KEI

The Mission of the DMZ Forum is to transfer the Korean DMZ from a symbol of war to a place of peace among humans and between humans and nature (www.dmz.forum.org).

Monday, 4 June 2007 | 09:00 - 17:00
IAIA07 delegates: \$100 / \$160 for others.

Special Pre-Conference Meeting

HIA-SIA Workshop

At IAIA06, a pre-conference workshop was held on the integration of health and social impact assessment. The workshop was attended by about 30 people. One of the conclusions of the workshop was that we needed to develop generic terms of reference that could be issued by project proponents to impact assessment consultants for integrated environmental, social, and health impact assessments.

Since the 2006 workshop, a small subcommittee has been working on a set of generic terms of reference that is based on a real example used in the oil industry for a developing country project (with the permission of the owners). The objectives of this pre-meeting workshop:

1. Review current experience with terms of reference.
2. Review, add to, and correct in detail the draft generic terms of reference prepared by the subcommittee.
3. Decide on a future course of action to disseminate and publish the final generic terms of reference.
4. Decide on the future of pre-conference workshops.

The workshop is open to any members of IAIA, or conference attendees who are interested in an integrated environmental, social, and health impact assessment terms of reference for use by consultants and their clients at the project level.

Monday, 4 June | 09:00 - 17:00
IAIA07 delegates: \$60 / \$120 for others

Social activities

Opening Reception

The Mayor of Seoul officially opens the conference with an address, as the City of Seoul welcomes delegates to an opening reception at the COEX Convention Center.

Monday, 4 June | 18:00-20:00
Grand Ballroom

Special Dinner

The Federation of Korean Industries will treat delegates with this special dinner. Celebrate the beginning of the conference with new colleagues and old friends.

Tuesday, 5 June | 19:30
Grand Ballroom

Fun Run

This popular 5 km sporting event is now in its fifth year.

Pre-registration is requested and a US\$5 fee will be collected on-site to cover organization and prizes. A great way to start the day and network with fellow runners! Walkers and cheerleaders are also welcome.

Sign up or check for information on the message board in the Lobby area.

Wednesday, 6 June | 06:00
The run will take place at Olympic Park. A bus will pick up and drop off participants at COEX Plaza.

Dine Out Seoul

Hosts will lead small groups to various restaurants in Seoul. Restaurants featuring local specialties and special emphasis on sustainable dining are offered. Participants pay their own way. Sign-up sheets are posted on the message board in the COEX 3rd floor lobby.

Wednesday, 6 June | 19:00 onward

Banquet

Relax with fellow delegates after a busy week. The Korean Ministry of the Environment treats delegates and guests to a pleasant banquet.

Thursday, 7 June | 19:30
Grand Ballroom

Technical visits

See page 31 for descriptions of technical visits. Registrations will continue to be taken until visits reach capacity.

Practitioners' Forums

IAIA conferences provide space for impromptu discussions in unanticipated/unscheduled areas of interest or to carry over discussions begun in concurrent sessions. White boards are provided in the Lobby area. In the morning, write in your proposed topic or sign up for a topic of interest to you. In the afternoon, topics are chosen and the locations are added to the flip chart. Groups then meet in those locations to hold discussion. The informality and spontaneity guarantee a lively end to the day's sessions.

Welcome to IAIA

This meeting is for any member who wants to know more about the organization, its history, and how it works; new or prospective Board members; or anyone interested in participating in IAIA as a Committee member or Section member. Chaired by IAIA CEO Rita Hamm.

Thursday, 7 June
14:30 - 16:00
Room 323
time:00-time:00

Conference Theme

Growth, Conservation and Responsibility

Promoting Good Governance and Corporate Stewardship through Impact Assessment

Mankind has excessively pursued economic growth from the prehistoric times, and particularly more so since the Industrial Revolution. While economic growth contributed to incredible human comfort, it irrevocably damaged environment where humans live. Thus, a problem arose in the late twentieth century: How do we reconcile economic growth with conservation of environment? The question becomes more problematic as cooperation among private corporations, governments, and the public becomes increasingly necessary and national boundaries become irrelevant.

Therefore, we seek to answer the urgent problem in the 27th Annual Conference of IAIA with the main theme of "Growth, Conservation and Responsibility." IAIA07 will explore the compatibility of economic growth with conservation and sustainability. By doing so, we hope to find the common interests among private corporations, governments, Indigenous Peoples, non-governmental organizations (NGOs), and practitioners. But since a nation alone cannot account for environmental damage, the conference will also address the perspectives of global responsibility. By gathering and discussing together, we hope that the conference will develop a new rationale by which economic growth and environmental conservation/sustainability can coexist. Numerous practitioners from across the world will obviously add fresh perspectives to transboundary and global environmental issues.

The last forty years have witnessed rapid economic development. With the economic development, however, environmental damage has ensued. In order to minimize the side effects of the economic growth, environmental experts have made assiduous efforts to implement impact assessment (IA). By holding the conference, we hope that discussions and reflections on economic growth and impact assessment (IA) practices will offer practitioners fresh insights.

IAIA07 will provide those present with ample opportunities to learn new perspectives. While it covers the traditional core topics such as SEA, SIA, HIA, biodiversity, and so on, it will also examine regional issues of Asian countries such as the DMZ (Demilitarized Zone) and transboundary issues.

The Annual Conference of IAIA has been an important venue where diverse practitioners discuss and debate their ideas, suggestions, and experiences. It also offers diverse courses by which students learn to do impact assessment. The Program Committee welcomes and urges enthusiastic participations from practitioners of diverse background and nationalities, and hopes that by sharing and exchanging their knowledge those present will make IAIA07 successful.

Welcome to Seoul for a memorable IAIA07.

Suh Sung Yoon

IAIA07 Program Committee Chair

Keynote Speakers

Welcome Addresses

Ross Marshall, President of IAIA

Chi-Beom Lee, Minister, Ministry of Environment

Suh Sung Yoon, Program Chair and President of KSEIA

Hoi-Seoung Jeong, President of Korea Environment Institute

Closing Addresses

Stephen Lintner, World Bank

Intergovernmental Policy Forum Summary

Charlotte Bingham, Incoming President of IAIA



Jeong-Jeon Rhee

Professor, Seoul National University Korea

Jeong-jeon Rhee, professor at Seoul National University since 1980, has taught and published broadly on environmental economics and sustainability.

While he has been devoted to teaching environmental economics and distributive justice, he has also been widely engaged in putting his ideas into practice.

He was the president of the Korean Association of Natural Resource Economics during 1989-1990, and later he became the co-president of the Green Consumers Network in 1996 and the director of Environmental Development Center in the Citizens' Coalition for Economic Justice in 1998.

He has been a member of the Central Advisory Committee to the Ministry of the Environment, the Land Use Review Panel, and the Metropolitan Maintenance Committee to the Ministry of Construction and Transportation. He has also actively participated in urban planning for the City of Seoul.



Maria Neira

Director of WHO Department of Public Health and Environment Switzerland

Dr. Maria Neira has a medical degree in medicine and surgery from the University of Oviedo (Spain) and she specialized in endocrinology and metabolic diseases at the Université René Descartes in Paris. She has a Master's degree in public health and a special diploma in nutrition both in Paris (France). She has also obtained an international diploma in emergency preparedness and crisis management from the University of Geneva (Switzerland).

At present, Dr. Neira is Director of the Department of Public Health and Environment at the World Health Organization, Geneva.

Between September 2002 and August 2005, she was President of the Spanish Food Safety Agency and Vice-Minister of Health at the Ministry of Health and Consumers Affairs in Spain.

Dr. Neira worked for the World Health Organization in Geneva in different positions, including Director of the Department of Prevention, Control and Eradication in the Cluster of Communicable Diseases Control. Before joining WHO, Dr. Neira worked as Public Health Adviser in the Ministry of Health in Mozambique from 1991 to 1993. She spent two years in Kigali, Rwanda, on assignment for the United Nations Development Programme (UNDP) from 1989. From 1987 to 1989, Dr. Neira was in El Salvador, Nicaragua, and Honduras as medical coordinator for Médecins sans Frontières.

Note: *The opening plenary will start on time. Delegates are encouraged to check in on Monday to avoid long registration lines prior to the opening plenary.*

Keynote Speakers



Yong Chung

Professor in Environmental Health, College of Medicine, Yonsei University in Seoul Korea

Professor Yong Chung is a distinguished scholar in the field of Environmental Health Science and Environmental Impact Assessment in Korea. He has taught and researched since 1966. He has published some two hundred research papers and has served as a critical role-player on a variety of national projects in health risk assessment of drinking water, and of air pollutants in six cities and two industrial areas. He was also heavily involved in assessing environmental impacts in regions; examples of projects he has participated in include Health City Planning in Puchon City and the Sustainable Development Planning for Cheju Island. He also served on the National Project on Occurrence, Health Risk and the Control of Disinfection by Products (DBPs).

Professor Chung played a leading role in launching the Korean Society for Environmental Impact Assessment (KSEIA) and served as its first president. As a longtime member of the Central Advisory Committee, he gave critical consultations to the Ministry of Environment. He also served as the president of Korean Society of Environmental Toxicology. Since 2000, he has focused on health impact assessment in Sustainable Development Strategy. By continuing his efforts to raise awareness on environmental health through teaching, researching, and participating in many public projects, Professor Yong Chung has immensely contributed to establishing environmental health in Korea.



Rabel J. Burdge

Adjunct Professor, Department of Sociology and Huxley College of the Environment at Western Washington University and the School of Australian Environmental Studies, Griffith University in Brisbane United States

Educated at Penn State (Ph.D.) and Ohio State Universities (B.S. and M.S.), Dr. Burdge is currently a Professor Emeritus from the University of Illinois at Urbana-Champaign. He has also served on the faculties of the University of Kentucky (Lexington), the U.S. Air Force Academy, and as a Visiting Professor in the Department of Planning and Landscape and the Environmental Impact Assessment (EIA) Centre, University of Manchester in the United Kingdom, where he edited a double issue of the international journal, *Impact Assessment and Project Appraisal* Volume 21 (2&3) titled, "The Practice of Social Impact Assessment"

Burdge has authored numerous books, including *The Concepts, Process and Methods of Social Impact Assessment*, *A Community Guide to Social Impact Assessment*, *Coping with Change: an Interdisciplinary Assessment of the Lake Shelbyville Reservoir*. He co-authored *Social Change in Rural Societies: A Rural Sociology Textbook* and is former editor of the *Journal of Leisure Research* and founding co-editor of both *Leisure Sciences: an Interdisciplinary Journal and Society and Natural Resources: an International Journal*.

In 1990 he was elected President of IAIA and in 1994 received from IAIA the Rose-Hulman Institute of Technology Award for outstanding contributions to the field of impact assessment.

He is now serving a second four-year term (2007-2010) as a member of the Whatcom County (State of Washington) Planning Commission.



Stephen F. Lintner

Senior Technical Adviser, The World Bank United States

Dr. Stephen F. Lintner is currently the World Bank's Senior Technical Adviser on issues concerning environmental and social safeguard policies. He is responsible for Bank-wide coordination and oversight of measures to support the environmental and social soundness of Bank supported programs and projects. He is leader of the Quality Assurance and Compliance Unit (QACU) in the Operations Policy and Country Services Network. QACU provides Bankwide support for implementation of the ten safeguard policies and their associated disclosure requirements. These policies include environmental assessment, natural habitats, sustainable forestry, involuntary resettlement, indigenous peoples, physical cultural property, pest management, dam safety, international waterways and disputed areas. In addition, Dr. Lintner continues to represent the World Bank on environment and water resources management issues around the globe.

Since joining the Bank in 1988, he has worked as Senior Environmental Specialist in the Europe, Middle East and North Africa Region and Advisor for Freshwater, Coastal and Marine Resources in the Environment Department. He has also served in the East Asia and Pacific Region as the Regional Environmental Advisor. He was one of the authors of the Bank's original Operational Directive 4.01 on Environmental Assessment.

Prior to joining the World Bank, Lintner served as Environmental Coordinator for the Asia and Near East Bureau of USAID. He also worked for the United States Geological Survey and the Oriental Institute of the University of Chicago. Lintner holds a Ph.D. in Geography and Environmental Engineering from The Johns Hopkins University.

Program Overview

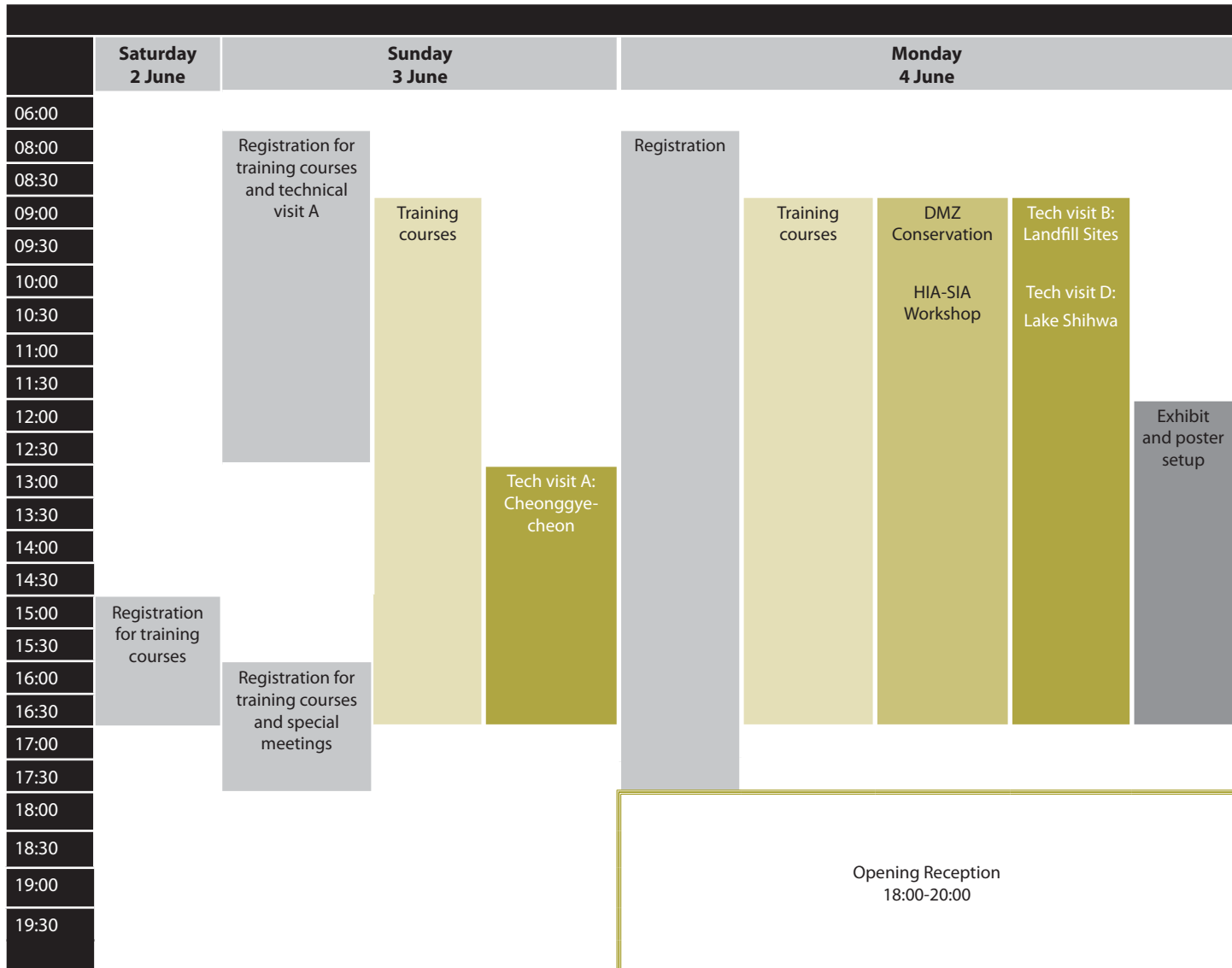

Program Overview

Tuesday 5 June	Wednesday 6 June	Thursday 7 June	Friday 8 June	
	Fun Run			06:00
Committee meeting Registration opens	Committee meetings Registration opens	Section meetings Registration opens		08:00
				08:30
Opening plenary	Theme Forums	Theme Forums	Closing plenary	09:00
				09:30
				10:00
Break	Break	Break	Break	10:30
Opening plenary continued	Theme Forums	Theme Forums	Awards and closing plenary	11:00
				11:30
				12:00
Poster session	Annual General Meeting	Council meeting		12:30
				13:00
Lunch	Lunch	Lunch	Tech visit C: Seoul Forest	13:30
				14:00
Concurrent sessions	Concurrent sessions	Concurrent sessions		14:30
				15:00
				15:30
Break	Break	Break		16:00
Concurrent sessions	Concurrent sessions	Concurrent sessions		16:30
				17:00
				17:30
Practitioners' Forums	Practitioners' Forums	Practitioners' Forums	Exhibit and poster takedown	18:00
				18:30
				19:00
Special Dinner 19:30 onward	Dine Out Seoul 19:00 onward	Banquet 19:30 onward		19:30

Notes

Daily Schedule

Saturday, 2 June

15:00-17:00 **Registration** (Jangbogo Lobby)
Training course participants only

Sunday, 3 June

08:00-13:00 **Registration** (Jangbogo Lobby)
Training course and technical visit A participants

09:00-17:00 **Training Courses**
Room numbers will be provided at check-in.
1a. Biodiversity: Key Sector Best Practices
3. SEA in Development Cooperation
4. Social Impact Assessment
5a/b/c. SEA (Groups 1, 2, and 3)
7. Understanding Impact Assessment
8a/b. Practical Guide to Sustainability Assessment
10. Principles & Practice of Health IA

13:00-17:00 **Technical Visit A: Cheonggyecheon**

16:00-18:00 **Registration** (Jangbogo Lobby)
Training course and special meeting participants

Monday, 4 June

08:00-18:00 **Registration** (Jangbogo Lobby)

09:00-17:00 **Training Courses**
Room numbers will be provided at check-in.
1a/b. Biodiversity: Key Sector Best practices
3. SEA in Development Cooperation
4. Social Impact Assessment
5a/b. SEA (Groups 1, 2)
5c. SEA (Group 3)
7. Understanding Impact Assessment
8b. Practical Guide to Sustainability Assessment
9. Practical Guide to Effective IA Follow-Up
11. Multi-Criteria Decision Analysis

09:00-17:00 **Korea's Demilitarized Zone (DMZ) Conservation: Science and Impact Assessment** (310 A/B/C)
See page 4 for information.

09:00-17:00 **HIA-SIA Workshop** (311 A/B/C)
See page 4 for information.

09:00-17:00 **Technical Visit B: Landfill Sites**

09:00-17:00 **Technical Visit D: Lake Shihwa**

12:00-17:00 **Exhibit and Poster Setup**

18:00-20:00 **Opening Reception** (Grand Ballroom)
Sponsored by the City of Seoul

Tuesday, 5 June

08:00-11:00 **Registration** (Grand Ballroom Lobby)

08:00-09:00 **Committee Meeting**
• IAPA Editorial Board (304A)

09:00-10:30 **Opening Plenary** (Grand Ballroom)
Simultaneous interpretation to be provided.
Chair: Suh Sung Yoon, President of KSEIA

- **Introductory Video**
- **Welcoming Address.** Ross Marshall, President of IAIA
- **Welcome to Korea and IAIA07.** Chi-Beom Lee, Minister, Ministry of Environment
- **Welcome to the 27th Annual Conference of IAIA.** Suh Sung Yoon, President of KSEIA and Program Chair
- **Welcoming Address.** Hoi-Seoung Jeong, President of Korea Environment Institute

Keynote Address

- **How Global Warming Could Save Impact Assessment - But Only If We Make Some Changes.** Rabel Burdge

Break

Sponsored by Samsung

Opening Plenary Continued

Keynote Addresses

- **Challenges of EIA: EIA in Environmentally Sound Sustainable Development.** Yong Chung
- **Roles of EIA: The Merits and Limitations of EIA.** Jeong-Jeon Rhee
- **Bridging Gaps and Spanning Divides: Promoting Health Impact Assessment as a Pillar for Development.** Maria Neira

11:30-16:30 **Registration** (Jangbogo Lobby)

12:30-13:30 **Poster Session** (Conference Center Lobby)

13:30-14:30 **Lunch** (Jangbogo Hall 331-336)
Sponsored by Korea Water Resources Corporation (K-water)

14:30-16:00 **Concurrent Sessions**

16:00-16:30 **Break**
Sponsored by Samsung

16:30-18:00 **Concurrent Sessions**

18:00-19:00 **Practitioners' Forums**
See white boards in Conference Center Lobby for topic selections and room assignments.

19:30 **Special Dinner** (Jangbogo Hall 331-336)
Sponsored by The Federation of Korean Industries

Daily Schedule

Wednesday, 6 June

06:00	Fun Run See page 4 and message board in Conference Center Lobby for information.
08:00-16:30	Registration (Jangbogo Lobby)
08:00-09:00	Committee Meetings <ul style="list-style-type: none"> • Awards (321A) • Affiliates (321B) • Publications (321C) • Training & Professional Development (304A) • Sections Coordinating (304B)
09:00-10:30	Theme Forums <i>Simultaneous interpretation to be provided.</i> TF1. Addressing Social Issues through Corporate Stewardship (320A/B/C) TF2. Focus on Asia (311) TF7.1. Conservation and Economic Development: The Role of Biodiversity Offsets (I) (310)
10:30-11:00	Break <i>Sponsored by Samsung</i>
11:00-12:30	Theme Forums <i>Simultaneous interpretation to be provided.</i> TF4. Environmental and Social Leadership in Sustainable Financial Markets (320A/B/C) TF5. Responsibility Towards Your Neighbors: Transboundary Impact Assessment (311) TF7.2. Conservation and Economic Development: The Role of Biodiversity Offsets (II) (310)
12:30-13:30	Annual General Meeting (AGM) (402)
13:30-14:30	Lunch (Jangbogo Hall 331-336) <i>Sponsored by GS Caltex</i>
14:30-16:00	Concurrent Sessions
16:00-16:30	Break <i>Sponsored by Samsung</i>
16:30-18:00	Concurrent Sessions
18:00-19:00	Practitioners' Forums See white boards in Conference Center Lobby for topic selections and room assignments.
19:00	Dine Out Seoul See page 4 and the message board in the Convention Center Lobby for information.

Thursday, 7 June

08:00-16:30	Registration (Jangbogo Lobby)
08:00-09:00	Section Meetings <ul style="list-style-type: none"> • Strategic Environmental Assessment (304A) • Agriculture, Forestry & Fisheries (304B) • Public Participation (307) • Social Impact Assessment (308) • Environmental Management Systems (321A) • Environmental Law, Policies & Practice (321B) • Disasters & Conflicts (321C) • Biodiversity (330A) • IA of Trade-Related Policies (330B) • Health (330C) • Students and Early Professionals (323)

09:00-10:30

Theme Forums

Simultaneous interpretation to be provided.
TF3.1. Poverty and Impact Assessment (I) (311)
TF6. Utilization of Natural Resources Inventory Information (320A/B/C)
TF8. Generating Higher-Level Awareness of the Value of Impact Assessment (310)

10:30-11:00

Break

Sponsored by Samsung

11:00-12:30

Theme Forums

Simultaneous interpretation to be provided.
TF3.2. Poverty and Impact Assessment (II) (311)
TF9. Environmental Assessment and Conflict-Affected Areas: Before, During and After (320A/B/C)
TF10.1. IAIA and Capacity Development: Lessons Learned and Future Directions (I) (310)

12:30-13:30

Council Meeting

(402)

13:30-14:30

Lunch

(Jangbogo Hall 331-336)
Sponsored by Korea Chamber of Commerce and Industry

14:30-16:00

Concurrent Sessions

16:00-16:30

Break

Sponsored by Samsung

16:30-18:00

Concurrent Sessions

TF10.2. IAIA and Capacity Development: Lessons Learned and Future Directions (II) (321C)

18:00-19:00

Practitioner's Forums

See white boards in Conference Center Lobby for topic selections and room assignments.

18:00-19:00

Exhibit and Poster Takedown

19:30

Conference Banquet

(Grand Ballroom)
Sponsored by Korean Ministry of Environment

Friday, 8 June

08:00-11:30

Registration

(Jangbogo Lobby)

09:00-10:30

Closing Plenary

(Grand Ballroom)
Simultaneous interpretation to be provided.

Co-chairs: Suh Sung Yoon, Program Chair and President of KSEIA and Ross Marshall, President of IAIA

Keynote Address

- **Responsible Growth and Impact Assessment—Issues, Trends and Challenges.** Stephen Lintner

Intergovernmental Policy Forum Summary.

Break

Sponsored by Samsung

10:30-11:00

11:00-12:30

Closing Plenary Continued

- **Presentation of Awards.** Ross Marshall
- **Presidential Address.** Charlotte Bingham, Incoming President of IAIA
- **Invitation to IAIA08 in Perth.**
- **Closing of IAIA07**

13:30-18:00

Technical Visit C: Seoul Forest

Technical Program Overview

Theme Forums and Concurrent Sessions

Room	Tuesday, 5 June		Room	Wednesday, 6 June		
	14:30-16:00	16:30-18:00		09:00-10:30	11:00-12:30	14:30-16:00
320A	Asian SEA, EIA and Sustainability Assessment CS16.1	Asian SEA, EIA and Sustainability Assessment CS16.2	320A	Corporate Stewardship TF1	IFC and Sustainable Development TF4	Asian SEA, EIA and Sustainability Assessment CS16.3
320B	SEA CS23.1.1	SEA CS23.1.2	320B			SEA CS23.1.3
320C	SEA CS23.1.7	SEA CS23.1.8	320C			Health Impact Assessment CS15.4
311A	Health Impact Assessment CS15.1	Biodiversity & Ecology CS2.1	311	Impact Assessment in Asia TF2	Transboundary Impact Assessment TF5	
311B	Integrated Assessment of Trade-Related Policies CS18.1	Integrated Assessment of Trade-Related Policies CS18.2	310	Biodiversity TF7.1	Biodiversity TF7.2	
311C	Energy CS9.1	Energy CS9.2	330A			Biodiversity & Ecology CS2.2
304A	Public Participation CS20.1	Public Participation CS20.2	304A			Public Participation CS20.3
304B	Social Impact Assessment CS22.1	Social Impact Assessment CS22.2	304B			Social Impact Assessment CS22.3
307	Corporate Stewardship CS6.1	Environmental Management Systems CS12.1	307			Corporate Stewardship CS6.2
308	IA Law, Policies and Practice CS10.1	IA Law, Policies and Practice CS10.2	308			IA Law, Policies & Practice CS10.3
321A	Health Impact Assessment CS15.2	Health Impact Assessment CS15.3	321A			Health Impact Assessment CS15.5
321B	EIA Methodology & Practice CS8.1.1	EIA Methodology & Practice CS8.1.2	321B			EIA Methodology & Practice CS8.1.3
321C	Sustainability Assessment: Theory & Practice Workshop CS24.2.1	Sustainability Assessment: Theory & Practice Workshop CS24.2.2	321C			Sustainable Development CS24.1
310A	Environmental Information Technology CS11.1	Climate Change CS4.1	330B			Climate Change CS4.2
310B	SEA Capacity Development CS23.3	Transboundary Impact Assessment CS25	330C			Capacity Building CS3
310C	EIA and Early Market Involvement CS13.1	EIA and Early Market Involvement CS13.2	323			Land Use Planning & Landscape CS19.1

Technical Program Overview

Theme Forums and Concurrent Sessions

Thursday, 7 June					
	16:30-18:00	09:00-10:30	11:00-12:30	14:30-16:00	16:30-18:00
t	Asian SEA, EIA and Sustainability Assessment CS16.4	Agriculture, Forestry & Fisheries TF6	Disaster & Conflict TF9	Asian SEA, EIA and Sustainability Assessment CS16.5	
	SEA CS23.1.4			SEA CS23.1.5	SEA CS23.1.6
t	Health Impact Assessment CS15.6			EIA Methodology & Practice CS8.1.7	SEA CS23.5
	Indigenous Peoples CS17	Poverty & Impact Assessment TF3.1	Poverty & Impact Assessment TF3.2	Disaster & Conflicts CS7	Restoration CS21
	EIA Methodology & Practice CS8.1.8	Governance TF8	Capacity Building TF10.1	EIA Methodology & Practice CS8.1.9	EIA Methodology & Practice CS8.2
	Biodiversity & Ecology CS2.3			Biodiversity & Ecology CS2.4	Biodiversity & Ecology CS2.5
	Public Participation CS20.4			Public Participation CS20.5	Public Participation CS20.6
	Social Impact Assessment CS22.4			Social Impact Assessment CS22.5	Social Impact Assessment CS22.6
	Environmental Management Systems CS12.2			Governance CS14.1	Governance CS14.2
e	IA Law, Policies & Practice CS10.4			Agriculture, Forestry & Fisheries CS1.1	Agriculture, Forestry & Fisheries CS1.2
t	Health Impact Assessment CS15.7			Health Impact Assessment CS15.8	Health Impact Assessment CS15.9
ce	EIA Methodology & Practice CS8.1.4			EIA Methodology & Practice CS8.1.5	EIA Methodology & Practice CS8.1.6
t	Sustainable Development CS24.2			Sustainable Development CS24.3	Capacity Building (Follow-up to Theme Forum 10.1) TF10.2
	Climate Change CS4.3			Environmental Information Technology CS11.2	Environmental Information Technology CS11.3
	SEA in Vietnam CS23.2			Greening PRSP in Benin CS23.4	
	Land Use Planning & Landscape CS19.2			Welcome to IAIA	Land Use Planning & Landscape CS19.3

Theme Forums

Wednesday 6 June | 09:00-10:30 | Room 320A/B/C

TF1. Addressing Social Issues through Corporate Stewardship

Chair: Frank Vanclay

The Forum challenges conventional understandings of SIA by arguing that the addressing of social issues needs to be mainstreamed into corporate practice. SIA as traditionally conceived as point-in-time impact statements is not effective. The papers in the theme forum suggest that in order to meet Triple Bottom Line and Corporate Social Responsibility objectives, corporate practice needs to have a systems approach to addressing social issues. The focus needs to shift from minimising harm to adding value both for communities and corporations. The lead presentation will present a perspective from the field of SIA setting the stage, while the other presentations in the Theme Forum will present different views from consultants in the fields of corporate governance and community relations and from the corporate sector.

The Theme Forum is intended to:

- Improve corporate practice by featuring best practice in addressing social issues;
- Identify principles for corporate practice that consider social issues;
- Shift the understanding in Impact Assessment;
- Identify success factors for integrating Impact Assessment with other established corporate assessment tools;
- Demonstrate the value of Impact Assessment in clarifying the business case for CSR programs.

394. SIA as a Social Quality Assurance Process
Frank Vanclay, research-only professor of rural and environmental sociology in the Tasmanian Institute of Agricultural Research at the University of Tasmania in Hobart Australia

462. Promoting Good Governance and Corporate Stewardship Responsibly Through Successful Project Management of Social Impact Assessments
Siva Ram Vemuri, Associate Professor of Economics at Charles Darwin University, Australia

452. Determining the Business Value of Corporate Community Investment: Integrating Operations Management with Impact Assessment
Ana Maria Esteves, Principal of Community Insights Pty Ltd., Australia

708. Ensuring Quality Impact Assessments Through Corporate Governance
Francisca Wessels, Attorney specialising in Environmental, Health and Safety Law, South Africa

Wednesday 6 June | 09:00 – 10:30 | Room 311

TF2. Focus on Asia

Chairs: Myungjin Kim, Kii Hayashi

Focus on Asia gathers participants interested in Asian countries to exchange information on Asian EIA/SEA and to strengthen mutual relationships. This program includes invited speakers to present views on impact assessment in an Asian context and common Asian themes such as global warming, the Kyoto Protocol, public participation, and Green Growth with relation to EIA/SEA. Thus, it is a meaningful follow-up of "SEA/EIA development and cases in Asia" held in IAIA06 and also has a meaningful relationship to the "Asian SEA, EIA and Sustainability Assessment" session at IAIA07. Current and recently completed cases under the topic "Growth, Conservation and Responsibility" will be presented. This forum needs not just close cooperation among adjacent countries for the topic, but also broad perspectives from practitioners interested in Asian impact assessment.

The Forum format is presentations followed by discussion.

346. Environmental Issues in Mining Sector of Vietnam and Application of the Environmental Management System
Dang Hoan Le, Director, Vietnam-Korea Environmental Industry Co-operation Center, Vietnam

449. Experiences from Introducing Changes and Improvements of the EIA Systems in 6 Asian Countries, with Particular Focus on Improvements within Public Participation Processes (Indonesia, Iran, the Philippines, Sri Lanka, Thailand and Vietnam)
Albert Alupathage Kulatunga, Director, Special Projects Division at the Ministry of Environment, Sri Lanka

578. Recent Movement of Strategic Environmental Assessment in Japan
Sachihiko Harashina, Professor, Tokyo Institute of Technology, Japan

594. SEA and Integration of Development Planning and Environmental Planning in Korea
Jong Ho Lee, Professor, Cheongju University, Republic of Korea

666. Difficulty and the Possible Conservation Approach of Conservation in EIA of Project in China
Xuegong Liang, Researcher, Appraisal Center for Environment and Engineering, China

Thursday, 7 June | 09:00 – 10:30 | Room 311

TF3.1. Poverty and Impact Assessment (Session 1 of 2)

Chairs: Maria R. Partidário, Linda Ghanimé, Arne Dalfelt

Introduction by the chairs: "Why is the question of poverty and impact assessment essential?" followed by key speakers addressing the following questions:

1. Why is poverty increasing despite signs of global economic growth?
2. How can this trend be changed?
3. How can conservation and sustainable use of natural resources be most effective in securing long-term growth and poverty reduction?

What Pieces Are Missing in Addressing the Global Poverty Challenges?
Linda Ghanimé, UNDP

Poverty Situation and Poverty Environment Nexus in Vietnam
Dao Minh Chau, Swiss Development Cooperation

Reducing Poverty with Use of Environmental Assets for Human Development
Paul Steele, UNDP Environment Advisor

Thursday, 7 June | 11:00-12:30 | Room 311

TF 3.2. Poverty and Impact Assessment (Part 2 of 2)

Chairs: Maria R. Partidário, Linda Ghanimé, Arne Dalfelt

How can impact assessment best serve human development and poverty reduction?

Panel members open the discussion with 5-minute answers to each of the following:

1. How to bring the poverty dimension to the center of concerns and attention within the Impact Assessment arena?
2. What are the key bottlenecks and most promising solutions?

Discussion (one hour)

Concluding remarks by the chairs.

Theme Forums

Wednesday 6 June | 11:00-12:30 | Room 320A/B/C

TF4. Environmental and Social Leadership in Sustainable Financial Markets: IFC's New Performance Standards and the Equator Principles II

Chairs: Isabelle Paris and Anne Copeland Chiu

In May of 2006, IFC, a private sector arm of the World Bank Group, moved to implement its new Policy and Performance Standards on Social and Environmental Sustainability. Shortly after IFC's move, the Equator Principles, an environmental and social risk management framework used by major international banks in project financing, were updated to incorporate IFC's standards. Now with more than 40 participating financial institutions, the new Equator Principles have the potential to reach a large segment of the world's key projects in important sectors like infrastructure and extractive industries.

What are the IFC social and environmental standards underlying the Equator Principles? How are the standards implemented and what are the early lessons learned and key challenges? The event will explore these questions, and invite the participants to also share their experience.

Practitioners in ESIA will soon have to use this new framework as they will be contacted to provide due diligence for both Equator Bank assessment and IFC projects. They will benefit by adding an additional review tool, specifically designed for Private Sector Project and thus complementary to their existing sets of tools for development projects.

The Forum will consist of a one-hour joint presentation followed by ½ hour of discussion.

Isabelle Paris is currently a senior environment specialist at IFC, based in Washington.

Anne Copeland Chiu lectures at the University of Hong Kong on corporate responsibility, sustainability and environmental performance.

Wednesday 6 June | 11:00 – 12:30 | Room 311

TF5. Responsibility Towards Your Neighbours: Transboundary Impact Assessment

Chair: Weicher Schrage

Participants are expected, through interacting with the panel of experts, to gain an understanding of the mechanisms for effective transboundary EIA: transboundary EIA that not only efficiently satisfies legal and procedural requirements, but leads to better projects, impacts avoided or reduced, meaningful public participation, and cooperation and understanding between neighbouring States. It is also hoped that participants will provide insights into how such procedures may be improved.

The Forum will consist of introductory remarks by the chair (5 minutes) and then by each of the panellists (5-10 minutes each). Chair will then initiate questioning of the panel by the participants, with each being invited to respond to blocks of questions. The chair will then summarize the discussion, issues raised, ideas put forward, etc., with further input from the participants.

How Bilateral and Multilateral Agreements Provide Equity and Detail in Transboundary EIA Procedures, with Reference to a Draft Agreement Between the Countries of South-east Europe

Vania Grigorova: Bulgarian Ministry of Environment and Water (MoEW) and Chairperson of the Working Group on EIA under Espoo Convention

Cooperation in Transboundary EIA in the Baltic Sea Subregion

Sten Jerdenius, Swedish Ministry of Sustainable Development

Thursday 7 June | 9:00 – 10:30 | Room 320A/B/C

TF6. Utilization of Natural Resources Inventory Information

Chairs: Toshiaki Ohkura, Ryunosuke Hamada

An immediate objective of this particular forum of Utilization of Natural Resources Inventory Information (UNRII) is to initiate a stream to encourage participants to identify the meaning of UNRII. A next objective is to exchange ideas to establish holistic, useful and easy to access system for the utilization of NRII of local and global network. Further we hopefully reach a stage, through an exchange of opinions of participants to consider by the use of NRII, to justify pursuing maximizing solar energy incorporation at every site on Earth.

Participants will learn the importance of utilizing even commonly available NRII institutions such as museums, botanical gardens, and government agencies and they will realize the significant and positive meaning of daily practice of increasing solar energy incorporation through photosynthesis to be maximized everywhere.

784. Rural Landscape Information System (RULIS)

Dr. Shori Yamamoto, Senior Researcher, National Institute for Agro-Environmental Sciences, Japan

783. A Tentative Soil Map as an Inventory Based on the Recognition of Characteristics and Pedon Units of Urban Soils

Dr. Makiko Watanabe, Professor, Tokyo Institute of Technology, Japan

316. Soil Carbon Inventory Information and its Impacts on the Global Environment

Dr. Tomoyoshi Murata, Senior Researcher, National Institute for Environmental Studies, Japan

Presentation by Dr. Song Kwan-Choel

Dr. Song Kwan-Choel, Chief, National Institute of Agricultural Science and Technology, Korea

782. Concept of Natural Resources Inventory and Framework of Utilization

Dr. Toshiaki Ohkura, Senior Researcher, National Institute for Agro-Environmental Sciences, Japan

Theme Forums

Wednesday, 6 June | 09:00 – 10:30 | Room: 310

TF7.1 Conservation and Economic Development: The Role of Biodiversity Offsets (Part 1 of 2)

Chair: Kerry ten Kate

Mainstreaming biodiversity into development through biodiversity offsets is an emerging management tool for ensuring significant conservation outcomes. This Forum will be of interest to professionals involved in biodiversity conservation, EIA, business and development planning and project finance. Organised in two parts, it will provide an introduction to biodiversity mitigation within impact assessment, a review of recent developments and good practice in biodiversity offsets and market-based solutions and a moderated panel discussion.

This Forum will examine the benefits of incorporating biodiversity considerations in business policies and decisions and how to do so. It will review current thinking and share experiences on biodiversity offsets internationally, discuss the conservation and business risks and opportunities of biodiversity offsets, and discuss technical issues of biodiversity offset design and implementation.

Introduction to Biodiversity Offsets: Challenges and Potential Benefits

Kerry ten Kate, BBOP, Biodiversity Offsets Initiative and Investor Responsibility at Insight Investment

The Business Case for Biodiversity Offsets and Implementation Issues

Deric Quaile, Shell/IUCN

Offset Design Methodologies

Jonathan Ekstrom, Consultant

Jonathan Ekstrom, Consultant, specialises in biodiversity issues, risks and their management within both the private and public sector

Wednesday, 6 June | 11:00 – 12:30 | Room 310

TF 7.2. Conservation and Economic Development: The Role of Biodiversity Offsets (Part 2)

Chair: Jo Treweek

A panel discussion involving the audience where a perspective on the biodiversity offsets and integration of biodiversity into EIA will also be provided by Asha Rajvanshi.

Dr. Asha Rajvanshi, Wildlife Institute of India

Dr. Jo Treweek, ecologist and Technical Programme Manager of IAIA's Capacity Building in Biodiversity and Impact Assessment (CBBIA) Project

Thursday, 7 June | 09:00 - 10:30 | Room 310

TF8. Generating Higher-level Awareness of the Value of Impact Assessment

Chair: Wes Fisher

As impact assessment practitioners, we have an increased chance of reaching new and influential audiences and building support for our profession if we can convey impact assessment's value in memorable and succinct forms. This forum will share ideas, experiences and methods for reaching decision-makers who may have no previous exposure to impact assessment, but who are in positions of influence, and who may control funding for Impact Assessment preparation, EIA review, Environmental Management Plan preparation, implementation and follow-up. Individual presenters will serve as a panel and will speak for no more than 10-12 minutes, leaving 40 minutes for open Forum discussion and recommendations for action.

Peter Croal, Canadian International Development Agency (ACDI-CIDA): Peter will summarise some of ACDI-CIDA's efforts to generate awareness of EIA's value. Peter intends to have a brief conversation with the group and then seek ideas from Forum participants on the most effective approaches for reaching decision-makers.

Luis Montañez-Cartaxo, Environmental Impact Assessment Vice Manager, Environment Protection Division of Mexico's Federal Commission of Electricity (CFE): Luis is interested in discussing how to convince decision-makers and politicians of the importance of ensuring that reasonable environmental and social impacts are fully taken into account in the conceptualization and design of a project, and that actions to prevent or manage them are monetised.

Peter Tarr of the Southern African Institute for Environmental Assessment (SAIEA): Peter will deliver an address as a Minister of Planning – to show how different his thinking is to all those Sustainability Development advocates who trawl the corridors of IAIA conferences.

Wes Fisher, The Cadmus Group: Wes will present a skit that summarizes the interaction of an EIA professional with the President and Minister of Transportation of a developing country just emerging from disaster emergency conditions. The dialogue centers on the proposed reconstruction and improvement of a 1000 km highway and involves an effort to convince decision makers to use EIA as tool for sound environmental design and management. The skit is meant to illustrate to decision-makers the potential adverse effects of inadequate stakeholder involvement/public participation, and insufficient attention to mitigation and monitoring plan (Environmental Management Plan) preparation, budgeting, implementation and follow-up.

Thursday, 7 June | 11:00 – 12:30 | Room 320A/B/C

TF 9. Environmental Assessment and Conflict-affected Areas: Before, During and After

Chairs: Michel A. Bouchard, Charles Kelly, Annica Waleij, Grant Wroe-Street

Armed conflict and war are major impediments to sustainable development in numerous countries. In addition to well-known dramatic humanitarian effects, they lead to less well-known serious and important environmental impacts. From degradation of natural resources, such as water, agricultural land, forest and biodiversity to collateral environmental damages such as oil spills, and finally to the collapse of environmental governance, environmental impacts of conflicts may seriously affect post conflict rehabilitation and reconstruction and may sustain conditions of personal civil unrest afterwards. Numerous examples of such damages are now well documented from conflict-affected areas including more recent examples in Lebanon.

There is an urgent need to familiarize the impact assessment community with the needs to contribute best practices, efficient methods, and state-of-the-art standards to be applied in emergency or conflict-affected areas. Participants will learn about the issues, the needs, the constraints and the usefulness of EA tools for the benefit of mankind.

The format is that of an expert panel and a focused discussion with participants. The expert panel will be composed of:

Michel A. Bouchard, Centre International des technologies de l'Environnement de Tunisie and McGill-UNEP Collaborative Center in Environmental Assessment, Canada

Grant Wroe-Street, UNEP Post-Conflict Branch, Geneva, Switzerland

Annica Waleij, Swedish Defence Research Agency, Umea, Sweden

Charles Kelly, Benfield Hazard Research center, London, UK

Lisa Goldman, Environmental Law Institute, Washington

The discussion will focus on

- Tools for environmental assessment in emergency situations or conflict-affected areas
- How to reconcile protection of peacekeeping mission with environmental protection
- Tools to prevent or mitigate environmental impacts
- How to fill the gap between the community of practice of IAIA and humanitarian and peacekeeping community
- How environmental impact assessment can contribute to relief, recovery and reconstruction alongside with sustainable development after a disaster or a conflict
- The application of SEA as a form of "environmental intelligence" before the conflicts, and as a standard tool for post-conflict rehabilitation/reconstruction

Thursday, 7 June | 11:00 – 12:30 | Room 310

TF 10.1. IAIA and Capacity Development: Lessons Learned and Future Directions (Part 1 of 2)

Chairs: Charlotte Bingham, Petrie van Gent

This Forum will take stock of the capacity development efforts undertaken by IAIA, extract lessons learned (do's and don'ts), and determine the most promising directions for capacity development in the future. The latter will be focused on a concrete capacity development proposal prepared by IAIA, but also leaves the floor open to new options.

Session I:

- Short introduction to the sessions;
- 3 presentations on capacity building initiatives, initiated by IAIA. Presentations take 15 minutes each plus 5 minutes for questions;
- 30 minutes discussion to get a broad overview of do's and don'ts in IAIA's capacity development.

Jo Treweek, coordinator of IAIA's Capacity Building in Biodiversity and Impact Assessment (CBBIA) Project

The International Association for Impact Assessment (IAIA) Capacity Building for Biodiversity and Impact Assessment project (CBBIA) purpose, objectives and activities and summarize the main lessons learned: some key successes and failures will be presented as a basis for discussion.

Mario do Rosario Partidario, Associate Professor at IST – Technical University of Lisbon in Portugal

Partidario served as an IAIA co-team leader for a team of IAIA SEA experts to collaborate with World Bank and China's State Environmental Protection Administration (SEPA) on a Distance Learning Course (DLC) on SEA for China and will provide an update on the current delivery of this distance learning course and the subsequent effects that this capacity-building initiative in China is now generating.

Petrie van Gent, Knowledge manager International cooperation with the Netherlands Commission for Environmental Assessment (NCEA)

This presentation will cover three IAIA capacity building activities: the training courses preceding the annual IAIA conferences, the stipend programmes that have been provided by the Netherlands and Swedish Governments over a number of years and the Good practices series as published on IAIA's website. The presentation will explain the activities, summarize the outcomes of a quick scan evaluation of these activities and the resulting do's and don'ts.

Thursday, 7 June | 16:30-18:00 | Room 321C

TF10.2. IAIA and Capacity Development: Lessons Learned and Future Directions (Part 2)

Chairs: Charlotte Bingham, Petrie van Gent

Session II

- Recap of Session I
- Panel introductions (30 minutes). The panel comprises the speakers of the first session together with persons related to the current capacity building proposals. The latter will give short introductions to the current IAIA capacity development proposal (Lee Wilson) and other initiatives (Weston Fisher on the mentoring programme) and possibly also a donor's view.
- Group discussions on gaps and needs, lessons learned and the current proposals (40 minutes).

Concurrent Sessions

Tuesday, 5 June

14:30-16:00

CS16.1 Asian SEA, EIA and Sustainability Assessment

Room: 320A
Chairs: Kii Hayashi, Lindemark Helena, Do Trong Nhan

- 378. Making EA Work for Sustainable Development: A Synthesis of Experiences from Seven Countries in Asia (China, India, Jordan, Lao PDR, Malaysia, Nepal and the Philippines)**
Chenyang Zhu, Pawan Kumar Labhasetwar, Nuha Salah, Ekvinay Sayyath, Khew Swee Lian, Gokul Prasad Burlakota, Belinda Fajardo, Natividad F. Lacadan
- 446. Experiences from Introducing Changes and Improvements within Post-EIA Monitoring in Seven Asian Countries (India, Malaysia, Mongolia, Pakistan, the Philippines, Sri Lanka and Vietnam)**
Chandrashekhar Anantrao Moghe, Sharifah Zakiah Syed Sahab, Monkhtulga Monkho, Mir Sajjad Hussain Talpur, Elsie P. Cezar, Wijesooriya A.D.D. Wijesooriya, Udayachandra Ratnawansha Bandara, Pham Anh Cuong
- 448. SEA Trends in Asia: A Summary of Experiences from Six Asian Countries (China, Iran, Mongolia, Philippines, Sri Lanka and Vietnam)**
Xinfeng Zhao, Bahman Jabbarian Amiri, Myagmar Ravdan, Criste Z. Navida, Kanthi De Silva, Nilmini Kumari Attanayake, Le Hoai Nam, Pham Thi Mai Van

CS23.1.1 SEA: Implementation

Room: 320B
Chair: Daniel Bongardt

- 730. Experience of SEA in Scotland**
Amanda Chisholm, Jennifer Craig
- 775. Health**
Lone Kørnøv
- 248. SEA: The Missing Link Between Directive and Practice**
Virginio Bettini, Chiara Rosnati
- 11. An Introduction to SEA of Urban Comprehensive Transportation Plans**
He Xu, Meng Liu, Jing Wu, Chen Wen

CS23.1.7 SEA: Research and Evaluation

Room: 320C
Chair: Alfred Herberg

- 413. The Influence of Urban Development Density on Water Pollution**
Kyushik Oh, Dongwoo Lee
- 414. Air Pollution and New Town Developments in the Seoul Metropolitan Area**
Kyushik Oh, Seunghyun Jeong
- 535. An Evaluation of Recent SEA practice in Brazil**
Luis Sanchez

CS15.1 Health Impact Assessment: HIA National Systems-Experiences and Perspectives

Room: 311A
Chair: Lea den Broeder

- 512. Health Impact Assessment as a Health Promotion Tool Applied in Old European Union Member Countries and Obstacles of Introducing of Introducing HIA in New Member Countries**
Mariusz Geremek, Joanna Kobza, Joanna Wozniak
- 490. The New Era of HIA in Thailand: The HIA Annual Report 2006 and the Strategies for Future HIA Development in Thailand**
Supakit Nuntavorakarn, Decharut Sukkumnoed, Wipawa Chuenchit
- 312. Introduction Scheme of Health Impact Assessment in Korea**
Im Soon Kim, Young Han Han, Joo Hyun Park, Suk Woo Han, Sang Wook Han
- 108. Environmental Health Impact Assessment for Development Projects in Asia**
Sweelian Khew, Kazal Sinha

CS18.1 Integrated Assessment of Trade-Related Policies

Room: 311B
Chair: Rachel McCormick

- 238. Environmental and Moral Consequences of Industrialized Meat Production and Trade**
Kirsten Oleson, Marshall Burke, Ellen McCullough, Joanne Gaskell
- 587. Preliminary Assessment of the Economic and Environmental Impacts of a Canada-Korea FTA**
Dan Ciuriak, Shenjie Chen
- 776. Tailor Made Strategic Environmental Assessment of Trade Agreements**
Johan Brons

CS9.1 Energy: Energy Development Impacts-North American Perspective

Room: 311C
Chair: Imogen Crawford

- 262. SERPENT of the Deep – Best Practices in Research, Monitoring and Partnerships for a Deepwater Well off Atlantic Canada**
Andre d'Entremont, Janne Kaariainen, Krista Baker
- 445. SERPENT Project: Industry and Academia Join Forces to Improve Impact Management in the Deep Sea**
Janne Kaariainen
- 545. The Role of Environmental Impact Assessments in Onshore Pipelines**
Imogen Crawford
- 556. Socio-Economic Impacts of Large-Scale Natural Resource Projects in Canada: Lessons Since the 1990's**
Anne-Laure Bouvier, Solange Van Kemenade, Jean-Philippe Waaub, Christiane Gagnon
- 237. Balancing Between Geothermal Energy Capacity Expansion and Wildlife Conservation in Kenya's National Parks/Game Reserves with Geothermal Energy Potential**
Gabriel Wetang'ula

CS20.1 Public Participation: New Spaces of Governance

Room: 304A
Chair: Bert Enserink

- 278. EIA and Direct Democracy: Challenges for Top-down Participation**
Pekka Hokkanen
- 387. Participatory and Technocratic Approaches to IA: Getting the Best of Both Worlds**
Jacki Schirmer
- 484. Mediated Representativity: The VPA AIDS and Rural Development**
Loes Witteveen, Rico Lie, Bert Enserink

CS22.1 Social Impact Assessment in a Developmental Context

Room: 304B
Chair: Ilse Aucamp

- 280. Humbo and Soddo Community-Managed Natural Regeneration Project: Social Assessment**
Mesfin Admasu
Recipient of the IAIA President's Bursary 2007
- 366. Socio-Economic Impact of Urbanisation on Indigenous People of Urban Areas: Case Study of Rebisi People of Port Harcourt City, Nigeria**
Prince Chinedu Mmom
- 567. Implementing Social Issues in a Trunk Road Project in China**
Rita Ohene Sarfoh

CS6.1 Corporate Stewardship: Corporate Social Responsibility-Business Case for Impact Assessment

Room: 307
Chair: Angela Pinilla Urzola

- 306. Role of Environment and Social Impact Assessment in Corporate Social Responsibility**
Duncan Oyaro
- 642. The Environment Impact Assessment as an Element of a Social Corporate Responsibility Concept: The Example of the BTC Oil Pipeline**
Manfred Kirchgorg, Elke Nickel
- 308. Environmental Stewardship, EIAs and the Private Sector in Guyana: An Uneasy Alliance?**
Paulette Bynoe
- 443. The Development of Environmental and Social Programs for a Major Infrastructure Project - Lessons Learned from a Private Corporation Perspective**
John Saczkowski, Graeme Smith, Augusto Flores, Michael Hooper

CS10.1 Impact Assessment Law, Policies and Practice: Asian Experiences

Room: 308
Chair: Jan De Mulder

- 135. Revising the Regulation of Project Approval for EIA in Lao PDR**
Somphath Souvannavong, Viengkhone Bouaphachanh, Villavan Bouvovone, Vivath Sauvaly, Akiko Urago
- 172. Trial of SEA in Project Approval in Lao PDR**
Vivath Sauvaly, Somphath Boudphommueng, Akiko Urago

Concurrent Sessions

Tuesday, 5 June

16:30-18:00

271. Environmental Mainstreaming in Bhutan
David Annandale, Karma C. Nyedrup

186. An Assessment of the Effectiveness of the Environmental Monitoring System in the Halsema Road Rehabilitation Project in the Philippines
Rosemarie del Rosario

CS15.2 Health Impact Assessment: Practice into Theory

Room: 321A
Chair: Kyungho Choi

407. Ethics of HIA
Marco Martuzzi

371. Environmental Impact Assessment for the Construction of Foreshore Protection in the Niger Delta, Nigeria
Confidence Kinikannwo Wachukwu

241. A Fault Analysis for Health Impact Assessment: Procurement, Competence, Expectations, and Jurisdictions
Martin Birley

652. Question Topics Covered in a Rapid HIA Workshop
Robert Quigley

728. Where Economic Regeneration and Human Health Collide: A Land Reclamation Scheme Incorporating Extraction of Coal by Opencast Methods in South Wales, UK
Alison Golby, Eva Elliott, Gareth Williams

CS8.1.1 EIA Methodologies and Practice

Room: 321B
Chair: Hyoun-Young Lee

574. Alternative Analysis (Cost-Benefit Analysis in EIA in Regard to Road Development Project in Korea)
Mihee Choi

601. Measuring Environmental Impact: The Use and Viability of the CV Method in the Case of Mexico
Jaime Martinez-Garcia, Eduardo Dela Maza-Borja, Jesus Pulido-Castañon

689. Cumulative Effects Assessments on Forest Damages by Additional Housing Development Projects
Eun-Young Kim, Dong-Kun Lee

703. The Analysis of Temperature Reduction Effect of an Extensive Greenroof
Seung-hwan Oh, Dong-kun Lee, Seong-wan Jang, So-won Yoon

CS24.2.1 Sustainability Assessment: Theory and Practice Workshop Session I-Knowledge, Integration and Sustainability

Room: 321C
Chairs: Jenny Pope, Angus Morrison-Saunders

607. Unsustainable Thinking: What Do We Need to Do to Truly Implement Sustainability Assessment?
Jenny Pope, Angus Morrison-Saunders

787. Stakeholders and Evaluative Integration: Opportunities and Incentives to Integrate Knowledge-Some Converging Threads
James Baines

234. Repositioning the Horse Before the Cart: A Relook at EIA
Alex Weaver

744. Integrating Multiscale Impacts in Megaprojects Assessment: Philosophy, Methodologies and Practical Issues
Leonardo Marotta, Giuseppe Magro, Enrico Tommasel, Stefano Picchio, Stefano Guerzoni, Virginia Bettini

CS11.1 Environmental Information Technology

Room: 310A
Chair: Kurt Fedra

516. Land Cover Identification of the Riparian Buffers Assigned to Paldang Water Resource Area Using IKONOS Satellite Image
Sung Ryong Ha, Seung Chul Lee, Chang Hwan Ko

380. Remote Sensing and Photointerpretation as Essential Tools for the Monitoring of Illegal Waste-Disposal Practices
Virginia Bettini, Massimo Morigi

692. An Integrated Information Management System of Surface, Subsurface, and Alternative Water Resources
Joon Hyun Kim, Natalia Yakunina, Sung Hoon Cho

684. Building of Web-Based Information System for Environmental Impact Assessment of Korea
Jeongho Lee, Gwang-Ho Park, Eui Sung Jung, Jeong-Hwa Hong, Jeong-Ho Yoon, Won-Mo Jeong

CS23.3 SEA Capacity Development

Room: 310B
Chairs: Nick Bonvoisin, Jiri Dusik, Ausra Jurkeviciute, Henrieta Martonakova

Experience in Capacity Development in Eastern Europe, Caucasus and Central Asia: Results and Lessons Learned
Henrieta Martonakova and Ausra Jurkeviciute

SEA and EIA Capacity Development Initiatives Within the Environment for Europe Ministerial Process
Nick Bonvoisin and Jiri Dusik

Other Future Capacity Development Activities in the UNECE Region: A Resource Manual, Further Pilot Studies and Networking of Russian-Speaking Experts
Nick Bonvoisin, Henrieta Martonakova and Ausra Jurkeviciute

Brainstorming and discussion on SEA capacity development world wide.

CS13.1 EIA and the Early Market Involvement

Room: 310C
Chair: Jos Arts, Charlotta Faith-Ell, Amanda Chisholm

529. Can Early Market Involvement Strengthen EIA?
Jos Arts, Charlotta Faith-Ell, Amanda Chisholm

741. Bridging the Gap Between EIA and Procurement
Berit Balfors, Charlotta Faith-Ell, Annika Varnäs

186. An Assessment of the Effectiveness of the Environmental Monitoring System in the Halsema Road Rehabilitation Project in the Philippines
Rosemarie del Rosario

729. Scottish Experience in Procurement and EIA of Roads
Amanda Chisholm

491. Early Contractor Involvement for Infrastructure Development: Experiences and Challenges
Roel Nijsten, Jos Arts

CS16.2 Asian SEA, EIA and Sustainability Assessment-Asian EIA and Effective Tool Development

Room: 320A
Chair: Jong Ho Lee

313. EIA Monitoring
Myagmar Ravdan

131. Modeling Phytoremediation of Heavy Metal Contaminated Mine Spoil Dumps
Parikshit Verma, Harsh Vardhan Singh, Satish Ramchandra Wate, Sukumar Devotta, Rishi Narayan Singh

500. Environmental Risk Assessment of High-Sulfur Gas Field Development in Complex Terrain
Fanghua Hao, Xiao Wang, Honhguang Cheng

372. Environmental Specimen Bank and Environmental Impact Assessment
Myungjin Kim, Byungho Yoo, Kyounghee Oh

CS23.1.2 SEA: Implementation

Room: 320B
Chair: Lone Kørnøv

9. Impact of Urban Development Plan on Land Use in Strategic Environmental Assessment: A Case Study of Wuhan City, China
Tao Tang, He Xu, Liang Guo, Guoping Jin

533. SEA in China - A Contribution to Environmental Policy Integration?
Holger Dalkmann, Zhou Yun

451. Transformation of German Transport Governance? Contribution of Strategic Environmental Assessment to Change in Transport Policy
Daniel Bongardt

471. SEA, a Contribution to Sustainable Urban Design - The Approach in Berlin
Alfred Herberg

12. Strategic Environmental Assessment in China: Status and Challenge
He Xu

CS23.1.8 SEA: Research Evaluation, Theories, Concepts and Guidance

Room: 320C
Chair: Yong Ha Park

731. Application of SEA to Different Types of Plans, Programmes and Strategies: Experience in Scotland
Amanda Chisholm

233. In Search of the Holy Grail: Exploring Causality in Strategic Environmental Assessment
Francois Retief

515. SEA for Strategic Assessment
Maria Rosario Partidário

283. SEA Approach for Global Warming: A Concept and Methodology
Vincent Onyango

668. Establishing SEA Guideline for Environment-Friendly Water Resources Development
Young-Il Song, Sunhee Jung, Cheoljin Kim, Gihye Shin

Concurrent Sessions

CS2.1 Biodiversity and Ecology: Best Practices for Mainstreaming Biodiversity Conservation in Infrastructure and Water Development Projects: Country and Sector Cases

Room: 311A
Chair: Asha Rajvanshi

- 309. Mainstreaming Conservation in Infrastructure Projects: Experiences from Latin America**
Juan Quintero
- 206. Development and Use of Water and Land Resources and Its Eco-Environment Issues in Xinjiang of China**
Yibing Qian, Zhaoning Wu
- 558. Economic Cost-Benefit Analysis of Environmental Impact of Hydropower Development Projects: A Case Study in the Upper Reaches of the Xiu River, China**
Fanghua Hao, Jiaxun Zhang Honhguang Cheng

CS18.2 Integrated Assessment of Trade-Related Policies: Alternative Methodological Approaches to Assessing the Impacts of Trade (Panel)

Room: 311B
Chair: Rachel McCormick

- The Benefits and Challenges of an in-House Approach to EA of Trade Negotiations: Perspectives from the Government of Canada**
Rachel McCormick
- Impact Assessment of the Euro-Mediterranean Free Trade Area**
Clive George
- Methodological Issues in the Impact Assessment of Trade Policy**
Colin Kirkpatrick
- UNEP's Integrated Assessment Methodology for Biodiversity Impacts of Trade-Related Policy in the Agriculture Sector**
Jo Trewick

CS9.2 Energy: Energy Growth and Impacts

Room: 311C
Chair: Anne-Laure Bouvier

- 439. Economic Growth, Energy Consumption and Pollutant Discharge Quantity Control of China**
Hongguang Cheng, Li Gong, Xiao Pu, Dan Wang
- 468. The Main Environmental Problems in China's Coal Mine Industry and the Counter-measures**
Haiqing Geng
- 779. The Impact of Renewable Energy Projects in Tanzania on Poverty Alleviation and Environmental Management: The Case of Biogas Use in Rungwe District South West Tanzania**
Agnes Mwakaje Kamanga
- 524. Meeting the Energy Needs of Under-served Consumers - A Novel Approach**
Ben Witchalls, BP Emerging Consumer Market Group
- 592. Energy and Products from Agricultural Biomass: Prospects and Issues**
F. Larry Leistritz, Donald M. Senechal, Nancy M. Hodur

CS20.2 Public Participation in Asia

Room: 304A
Chair: John Devlin

- 143. Public Participation in EA on Community Water Resource Development Project**
Yanyong Inmuong
- 362. Public Participation in Wastewater Treatment Planning in Thailand—Experimental Stakeholders' Meeting in Amphawa District**
Mihoko Matsuyuki, Raywadee Roachanakanan, Mizuo Kishita, Sadatsugu Nishiura, Bunlur Emaruchi, Kobkaew Manomaipiboon
- 463. Public Participation in Taiwan EIA**
Hsiao-Tien Wu, Wei-Chien Sun, Tung-Wan Chang
- 591. Public Involvement of English Style in the Process of Regional Spatial Strategy Development - Focusing on the South East Plan**
Takashi Shimizutani, Sachihiko Harashina

CS22.2 Social Impact Assessment: Social Conflict

Room: 304B
Chair: Ilse Aucamp

- 660. Enhancing Conservation through Integrated Social and Environmental Assessment: A Case Study from a Mining Project in Argentina**
Gillian Davidson, Pierre Pelletier, Sean Cullen, Andrew Burwood
- 235. Impact Assessment in the Face of Land Use Regulation: Dealing with Conflict through the Use of Stakeholders Dialogue**
Basilio Verduzco-Chavez, Nora Leticia Bringas
- 395. Environmental Conflict Management and Impact Assessment in Korea**
Deok-Gil Rhee

CS12.1 Environmental Management Systems: Linking EIA and EMS

Room: 307
Chair: Debra Zanewich

- 310. Possibilities of Strengthening of EIA Process by EMS and Vice Versa**
Andrej Ursic, Simona Ursic, Borut Mlakar
- 256. Environmental Impact Assessment (EIA) and Environmental Management Plan (EMP) on Melamchi Water Supply Project in Nepal**
Anil Khanal, Ram Bahadur Khadka, Suman Sharma
- 330. Environmental Impact Assessment in an Oil and Gas Company - Petroleum Development Oman Experience**
Maisoon Al Riyami
- 701. Impact of Mining on Community Water - Tarkwa Mine in Ghana**
Michael Ampim Sackey
- 768. Environmental Impact Assessment for Waste Treatment Options**
Seung Hoon Lee

CS10.2 IA Law, Policies and Practice: African Experiences

Room: 308
Chair: Jan De Mulder

- 218. Zoning the Kruger National Park: The 80 Year Blue Sky Scenario**
Sue Eber
- 247. Environmental Impact Assessment Legislation in Uganda**
Harriet Mujuni

- 675. EIA Review, Enforcement and Funding: Lessons Learned from a Strategic Review of Mali's EIA System**
Mark Stoughton

- 682. EIA Review and Follow-up: "Leadership Models" for EIA Effectiveness in Africa**
Mark Stoughton

CS15.3 Health Impact Assessment: Policies and Plans-Towards a Strategic Assessment of Health

Room: 321A
Chair: Ben Cave

- 406. Health and the SEA Protocol: Addressing Conceptual and Methodological Challenges**
Matthew Soeberg, Marco Martuzzi
- 511. Introduction to Health Impact Assessment - The Current Regional Decision-Makers Activity in Health Policy in Poland**
Joanna Kobza, Mariusz Geremek
- 369. Health Benefits of Reducing PM10 through the Seoul Air Quality Management Plan**
Jeongim Park, Hyunjoo Bae, Myung-Hyun Kim, Jong-sik Ha
- 623. An Online Guide for Inclusion of Health in EIA/SEA**
Lea den Broeder, Theo van Alphen, Ilse Storm, Anne Knol, Veronica ten Holder, Geert Draaijers

CS8.1.2 EIA Methodologies and Practice

Room: 321B
Chair: Hyoun-Young Lee

- 417. The Quality of Environmental Impact Statements of Waste Incineration Projects in Finland**
Kimmo Jalava, Sanna Pasanen, Markku Kuitunen
- 422. Environmental Impacts in Solid Waste Management Systems: An Impressive Case Study**
Vincenzo Belgiorno, Daniele Panza, Giuseppe Giannella
- 493. Environmental Assessment for the Large-Scale Waste Landfill Site in Seoul Metropolitan Area**
Jakon Koo, Muchoon Lee, Kyunga Lee
- 575. keystones and Outlines on Appraisal of EIA on Petroleum - Refinery and Ethylene Industrial Proposed Projects**
Shaoqing Zheng
- 612. A Consideration of the Hydraulic Simulation of a Dam to Reduce Algal Bloom**
Soon-Ju Yu, Sung-Ryong Ha, Dong-Il Jung, Jong-Yeon Hwang, Min-Hi Chae

CS24.2.2 Sustainability Assessment: Theory and Practice Workshop II- Sustainability and Decision-Making

Room: 321C
Chairs: Jenny Pope, Angus Morrison-Saunders

- 124. Sustainability Assessment of Poverty Reduction Strategy Papers**
Jean Hugé
- 734. A Framework for the Assessment of Bio-fuels's Sustainability: The Case of the Best Project**
Rocio Diaz-Chavez, Jeremy Woods
- 215. Evaluation of Sustainability in Spatial Planning and Management: Shortcomings in the Implementation of an Integrated Approach at Sub-Regional Scale**
Marta Olazabal, Gemma Garcia, Oscar Santa Coloma, Arantazu Urzelai, Efen Feliu, Itziar Aspuru

Concurrent Sessions

Wednesday, 6 June

14:30-16:00

487. Sustainable Development in Practice: Infrastructure for the Third Generation Mobile Telephone System in Sweden
Stefan Larsson, Lars Emmelin

273. Sustainability Appraisal and Flood Risk Management in England
Jeremy Carter

CS4.1 Climate Change: Impacts on Sectors

Room: 310A
Chair: Wha-jin Han, Jin Hwan Hwang

276. Vulnerability and Adaptation of Wetland-Based Ecosystems in Relation to Climate Variability and Extremes in Lake Victoria Basin
Madaka Tumbo

670. Coastal Setback: Precautionary Approach to Climate Change and Its Impact on Coastal Area in Korea
Jungho Nam, Jongdeog Kim

685. Prediction of Plant Communities Using Regional Climate Model in Korea
Jae-Uk Kim, Dong-Kun Lee

763. The Impact Assessment of High Wind in Youngdong Region
Jun Suk Hong

663. Typhoon Damage Impact Assessment of the Young-dong Region
Chang Yong Park, Hyoun-Young Lee

CS25 Transboundary Impact Assessment: Case Studies in EIA in a Transboundary Context

Room: 310B
Chairs: Wiek Schrage, Nick Bonvoisin

363. Post-Project Review on Navigation Channel Improvement Project of Upper Mekong River
Mikiyasu Nakayama, Naho Mirumachi

450. Improving Impact Assessment Methodologies in Transboundary Watercourses: Lessons from Africa and Asia
Lisa Goldman, Carl Bruch

CS13.2 EIA and the Early Market Involvement II

Room: 310C
Chair: Jos Arts, Charlotta Faith-Ell, Amanda Chisholm

780. Highway Privatization Impacts: We Can't Get No Satisfaction
James T. C. Wright

222. Integrating IA into M & E Systems
Ayn Grace Regalado

561. ESIA - No Longer a Tick in the Box for Oil and Gas
Ben Witchalls, Rob Finney, OGP ESIA Taskforce

538. EIA and Then What? Client and Contractor Responses to Environmental Requirements
Charlotta Faith-Ell, Kristina Lundberg

CS16.3 Asian SEA, EIA, and Sustainability Assessment: Asian SEA and New Direction

Room: 320A
Chair: Young-Il Song

520. The Evolution of Environmental Planning for Korea's Local Government
Do Kyung Lee, Mu Choon Lee, Min Ho Hong

356. Developing Sound Environmental City Center by Strategic Environmental Decision Making Approach in a Tokyo Business Center
Kii Hayashi, Shigeru Inoue

257. The Future of Korean Dam Construction and SEA
Jeong Min Yee, Cheol Jin Kim, Pil Joong Moon, Sung Woo Lee

CS23.1.3 Strategic Environmental Assessment: Introducing SEA Systems

Room: 320B
Chair: Sachihiko Harashina

175. Strategic Environmental Assessment in Land Use Planning for Poverty Reduction: Lesson from Tanzania
Alexander Chambi, Raphael Mwalyosi

347. The Experience of Developing the Methodical Provision for Conducting Strategic Environmental Assessment in the Republic of Belarus
Viktoryia Misiuchenka

658. Towards Sustainable Electricity Projects: The Establishment of Strategic Environmental Assessment in the Federal Commission of Electricity, Mexico
Francisco Javier Díaz-Perea, Luis E. Montañez-Cartaxo, María del Carmen Álvarez-Chávez, Vicente Aguinaco-Bravo

553. Growth Management and SEA
Sachihiko Harashina, Yuki Shibata, Terukazu Kumazawa

CS15.4 HIA Kaleidoscope: Environmental Factors

Room: 320C
Chair: Jeongim Park

447. Consideration of the Impacts of Noise in Health Impact Assessment and the Canadian Environmental Assessment Act
Margaux Brisco, Diane McClymont-Peace

486. HIA in the Health Assembly: Case Study of Health Hazards Prevention from Mining Policy, Thailand
Somporn Pengkam, Decharut Sukkumnoed

374. Assessment of Health Risk Exposure of Solid Waste Disposal Workers in Port Harcourt, Nigeria
Confidence Kinikanwo Wachukwu, Evangelin Eleanya

CS2.2 Biodiversity and Ecology: Global Responsibility for Integrating Biodiversity in Impact Assessment: Review of Experiences from around the World (Role of Business Groups and Other Country-Specific Efforts)

Room: 330A
Chair: Peter Croal

130. The First Step Toward Biodiversity Conservation in Shell Nigeria: The Biodiversity Action Plan for the Gilli-Gilli Forest Reserve
Oritsetimeyin Dada, Jonathan Amakiri

227. Integrating Biodiversity Conservation in Impact Assessment in Uganda
Berina Uwimbabazi

359. Building Capacity for Biodiversity-Inclusive Impact Assessment in the Regional Context
Asha Rajvanshi, Vinod B. Mathur

370. Integrating Environmental and Biodiversity Concerns in Development Planning Through Enabling Policy and Regulatory Framework
Vinod B. Mathur, Asha Rajvanshi

CS20.3 Public Participation: Contentious Issues

Room: 304A
Chair: Bert Enserink

117. Challenges of Public Disclosure of Social and Environmental Issues at the Local Level in Nigeria
Mohammed Hamadina

537. Political Contention, Public Participation and Political Mobilization: The Matola Hazardous Waste Incinerator
John Devlin

298. Druzhba-Adria Case Study. Public Participation Success Story: Public Pressure and Alliances against Poor Legislation and EIA as Legitimizing Device
Dusica Radojčić

CS22.3 Social Impact Assessment: SIA and Responsibility

Room: 304B
Chair: Ilse Aucamp

193. Role of Social Impact Assessment (SIA) in Development of Special Economic Zone (SEZs), an Indian Perspective
Chandrashekhar Moghe, Dilip Ramteke, Satish Wate

388. Using SIA to Develop Structural Adjustment Policy: Improving the Dialogue Between SIA Practitioners and Government
Jacki Schirmer

602. The "Awakening" of SIA in the Northwest Territories, Canada: The Mackenzie Valley Environmental Impact Review Board's Experience
Mary Tapsell, Alistair MacDonald

Concurrent Sessions

CS6.2 Corporate Stewardship: International Best Practice Session

Room: 307
Chairs: Charlotte Bingham, Angela Pinilla Urzola

386. Equator Principles

Maartje van Putten

664. IFC Performance Standards in Practice: A Methodology for Integrating Social and Environmental Effects for the Assessment of a Mining Project in Argentina

Andrew Burwood, Sean Cullen, Gillian Davidson, Pierre Pelletier

444. The Development of Environmental and Social Programs for a Major Infrastructure Project - Processes and Successes

John Sackowski, Graeme Smith, Augusto Flores, Michael Hooper

Environmental and Social Risk Management at Citi

Courtney Lowrance

CS10.3 IA Law, Policies and Practice: Thoughtful Impact Assessment and Practice

Room: 308
Chair: Jan De Mulder

672. Facility-Level Sustainability Reporting to Support Next-Generation Environmental Policy: The Experience of the Facility Reporting Project

Mark Stoughton

550. EIA Decision-Making and Natural Justice

Angus Morrison-Saunders, Gerard Early

706. 'Bling' and the Art of Impact Assessment

Rob Verheem, Angus Morrison-Saunders, Jos Arts

723. Avoiding Extinction: Proving the Business Case for IA and IA Practitioners

Francois Retief, Ross Marshall, Angus Morrison-Saunders

CS15.5 Health Impact Assessment: HIA National Systems: The Way Forward

Room: 321A
Chair: Suphakit Nuntavorakarn

398. Health Impact Assessment in Korea

Young Soo Lee, Young Ha Kim, Jin Hee Park

149. Build Up a Suitable Model for Health Impact Assessment on Current Situation of Vietnam

Hai Doan Ngoc

328. Health Impact Assessment: What We Should Do in Mexico

Julieta Pisanty-Levy

145. Applying Participatory Health Impact Assessment for Advocating Development of Healthy Public Policy in Thai Local Government Planning Processes

Uraivan Inmuong, Lertchai Charentanyarak, Peter Furu

CS8.1.3 EIA Methodologies and Practice

Room: 321B
Chair: Bhon K. Koo

191. Environmental Management Plan for CBM Exploration and Development in Damodar Valley, India

Harsh Vardhan Singh

440. Outcomes and Complexities of the EIA of a Large Hydro-Power Project in Mexico: The Implications of Introducing an Interdisciplinary Approach and the Benefits of Public Participation in its Early Stages

Sergio Contreras, Javier Clausen

539. Water Quality Simulation for Optimum Hydraulic Situation in Daechong Reservoir

SungRyong Ha, JaeYil Lee

702. A Study on the Fate of the Pollutant in Transitional Zones of Lake Juan

Hyun Saing Mun, Yu Jeong Huh, Su Young Park, Nam Ik Chang

CS24.1 Sustainable Development: Sustainable Development in Africa I

Room: 321C
Chair: Kwang Yim Kim

116. Economic Development versus Social and Environmental Sustainability: A cursory Look at Obajana Cement Project in Nigeria

Mohammed Hamadina

119. Impact Assessment and Environmental Sustainability in the Niger Delta Region of Nigeria: The Role of Government and Oil Companies Operating in the Region

Collins Ugochukwu, Jeurgem Ertel

144. Water Governance and Sustainable Use of Water Resources in Uganda Through EIA

Richard Osaliya

CS4.2 Climate Change: Impacts and Mitigation

Room: 330B
Chair: Wha-jin Han

585. SEA of a Problem: Climate Change

Miguel Coutinho, Raquel Pinho, Carlos Borrego

317. CDM&SEA: Potential Programmatic Future?

Holger Dalkmann, Daniel Bongardt

332. Emission Status of Air Pollutants for the Compliance of Climate Change

Jong-Gwan Jung, Gab-Sue Jang

CS3 Capacity Building

Room:330C
Chair: Axel Olearius

167. Capacity Building for Impact Assessment: Lessons and Experiences from Tanzania

Hussein Sosovele

577. Applying the OECD Guidance on Strategic Environmental Assessment. Capacity Development in the Context of German Technical Cooperation

Axel Olearius, Harald Lossack

767. Case Study - Capacity Building on Biodiversity and SEA in South America

Juan Carlos Garcia de Brigard, Juan David Quintero

508. Building Capacity for SEA in Brazil

Maria Rosario Partidário, Fabrício Amilivia Barreto, Ruy de Goes Leite de Barros, Leandro Freitas Couto, Izabella Teixeira, Vania Araújo Soares

568. The World Bank's Pilot Program on Institutions-Centered SEA

Fernando Loayza

CS19.1 Land Use Planning, Transportation, Landscape: Land Use in Urban Environment

Room: 323
Chair: Dongwon Shin

125. Economic Development, Urban Growth and Impacts: Issues of Livelihood, Vulnerability and Sustainability in Yenagoa Metropolitan Area, Bayelsa State, Nigeria

Meshach Ojile

361. Applicability of Strategic Environmental Assessment (SEA) to Urban Planning in Japan

Mizuo Kishita, Mihoko Matsuyuki, Sadatsugu Nishiura

389. Urban Development and Impact

Matilda Sotiri

678. Policies for Managing Urban Growth in the Seoul Metropolitan Region

Jin Hwan Kim

Wednesday, 6 June

16:30-18:00

CS16.4 Impact Assessment in Asia: Asian SEA, EIA and Sustainability Assessment-SEA/EIA Systems and Cases in Asia

Room: 320A
Chair: Kii Hayashi

752. Introduction of Case with a Series of Environmental Consideration from Location Selection to EIA in a Certain District in Japan

Ritsuko Sato, Yasusuke, Kurosaki

410. Environmental Impact Assessment (EIA) in the Philippines: Roads Taken, Lessons Learned for Mining Projects

Maria Lourdes Nanette Catalon, Melanie Manaog

772. Utilized Methods of Comparing Alternatives in Environmental Impact Assessment in Japan

Sachihiko Harashina, Yuki Miyashita, Nobuhiro Hara

225. An Emphasis on the Need for Systematic Review of the Environmental Impact Assessment Process in Iran

Feraidoon Ghodoosi, Ahad Sotoudeh, Reza Chalabianlou

CS23.1.4 Strategic Environmental Assessment: Methodological Aspects

Room: 320B
Chair: Xu He

136. Geographic Information Systems in Strategic Environmental Assessment: Can Spatial Data Improve the Process?

Ainhoa Gonzalez, Alan Gilmer, Ronan Foley, John Sweeney, John Fry

156. Anthropogenic Impacts on Pristine Socio-Ecological Whole-System Facing Directional Changes: Strategic Environmental Assessment in Bhutan Himalayas

Dipayan Dey

307. Development of Alternatives for Use in Strategic Environmental Assessment

Margaret Desmond

Concurrent Sessions

327. Strategic Environmental Assessment: The Challenges of Rolling Up Separate Planning Efforts
Cynthia Pratt

365. Ensuring High Quality Environmental Objectives, Targets and Indicators in Strategic Environmental Assessment (SEA)
Alison Donnelly, Terry Prendergast, Mike Jones, Tadhg O'Mahony

CS15.6 HIA Capacity Building in Mekong Countries

Room: 320C
Chair: Robert Bos

647. Progress Report on HIA Capacity Building Activities in the Mekong Region 2003-2007
Peter Furu

355. HIA Capacity Building in Lao PDR: Formulating a National HIA Policy and Setting Up an Institutional Structure
Soutsakhone Chanthaphone

HIA Capacity Building in Cambodia: Health in Existing EIA Practice
Duang Samkeat

HIA Capacity Building in Viet Nam: Taking Capacity to Scale at the Provincial Level
Tran Thi Ngoc Lan

HIA Capacity Building in Thailand: Lessons to Be Learned
Yanyong Inmuong

HIA in the WHO Region of the Western Pacific: Status and Outlook
Hisashi Ogawa

Discussion.

CS17 Indigenous Peoples

Room: 311
Chair: Eric Brusberg

166. Identification of the Social and Environmental Impact Assessment of the Land Titles Policies on the Indigenous Populations of the Peruvian Amazonia. Consolidation of the Communal Property of the Indigenous Communities Asháninka as a Strategy
Nancy Milagros Ortega Vásquez

603. Involving Canada's Indigenous Peoples in Environmental Assessment: Co-Management through the Mackenzie Valley Environmental Impact Review Board
Gabrielle Mackenzie-Scott, Vern Christensen, Graham White

646. Poverty and Inclusion of Indigenous Peoples
Ginette Lajoie

659. Creating Inclusive Environmental Assessments in Canada: Examples from Northwest British Columbia
Gillian Davidson

CS8.1.8 EIA Methodologies & Practice

Room: 310
Chair: Suk Jo Lee

185. A Study on Individual Perceptions of Road Traffic Noise
Belinda Fajardo

249. Navigating the Maze: Coordinating Multiple EA Frameworks for an International Transportation Project
Kaarina Stiff

400. The Ranges of Magnetic Fields in High-voltage Transmission Lines for Evaluation of Environmental Impact
In-Soo Jeon

527. Alternatives and Assessment in Large-scale Projects – The Öresund Bridge Case
Eric Markus

CS2.3 Biodiversity and Ecology: Importance of Integrating Biodiversity in Impact Assessment and Decision Making for Promoting Economic Growth and Human Welfare: Developing Links for Best Practices

Room: 330A
Chair: Jo Treweek

195. Appropriate Assessment Practices and Reports in Finland
Tarja Söderman

333. Early Findings from the Appropriate Assessment of Plans as Required by the Habitats Directive 92/43/EEC
Orlando Venn, Jo Treweek

367. Human Density, Industrialisation and Economic Growth in the Niger Delta, Nigeria: An Assessment of Their Impact on the Mangrove (Forest) Resources
Prince Chinedu Mmom

CS20.4 Public Participation: Public Participation in Western Countries

Room:304A
Chair: John Devlin

492. Social Learning for Better Water Management – Insights from the EU HarmoniCOP Project
Bert Enserink

502. Public Participation in the North American Agreement on Environmental Cooperation
Aranka Podhora

456. Waste Facility Siting and Citizen Involvement in US
Akino Tahir

CS22.4 Social Impact Assessment: The Relationship Between SIA and the Government (Roundtable)

Room: 304B
Chair: Ilse Aucamp

How well do those in government understand what impact assessment can contribute? What can be done to improve their understanding?

An open discussion with interested members will be conducted. Matters to discuss include the relationship between government organisations e.g., mining, water affairs, economic affairs, environmental affairs, social development, agriculture and SIA.

CS12.2 Environmental Management Systems: EMS: Implementation of Environmental Management Systems

Room: 307
Chair: Angela Pinilla Urzola

764. East-West, Home Is Best: The "Komi-Aluminium Project" and Lessons Learned
Marina Khotuleva, Sean O'Beirne, Egor Yurkin

250. How an Electrical Distribution Company in Brazil Is Reducing Environmental Impact by Means of EMS
Sandra Neusa Marchesini Ferreira, Roberta Soares Gávido

773. Occupational Health and Safety Management Systems - Organisational Approach Towards Implementation
Tine Herreborg Jørgensen, Mette Mosgaard

438. Informing the Environmental Impact Assessment of Major Pipeline Projects Through the Use of Environmental Management Systems Information
Kent Lien, Ken Colosimo

CS10.4 Environmental IA Law, Policies & Practice: Worldwide Experiences

Room: 308
Chair: Jan De Mulder

318. Russian-German Manual on Environmental Impact Assessment
Wolfgang Wende, Anja May, Koeppl Johann

431. Role of EIA on the Decision-Making Process for Hazardous Waste Management Facilities in Mexico
Maria Teresa Gomez Osorio, Dick Cobb, Alan Bond

151. Evolution and Evaluation of the EIA System in Iran
Hossein Moradi, Bernhard Schmid

4. EIAs of Road Project in Japan
Shinri Sone, Yoshiharu, Namikawa, Fumiharu Adachi

353. Actual Condition of EIA Review Committees in Japanese Local Governments
Shigeo Nishikizawa

724. A Comparative Analysis of Environmental Impact Assessment Law, Policies, and Practices in Latin America
Ernesto Sanchez-Triana, Santiago Enriquez

CS15.7 Health Impact Assessment: HIA Kaleidoscope: Physical Health Factors

Room: 321A
Chair: Eenjeong Kang

412. How to Promote Dietary Fiber: From a Simple Message to a Complex Policy
Peter Gry, Gabriel Gulis, Marco Martuzzi, Matthew Soeberg, Peter Otorepec, Elżbieta Grochowska-Niedworok

379. Effect of Lime (Quick Lime CaO) Stabilisation on Intestinal Pathogens in Domestic Septage: A Pre-Disposal Treatment
Confidence Kinikanwo Wachukwu

349. Environment and Health Impact Assessment of Pesticides Use for Public Policy Decision Support in Local Level
Jittima Rodsawad, Navin Sopapoom

CS8.1.4 EIA Methodologies & Practice

Room: 321B
Chair: Bhon K.Koo

179. Cooperate Stewardship in Conservation through Impact Assessment: The Case of Grumeti Reserves Limited in Serengeti, Tanzania
Beatrice Mchome

470. Analysis of Three-Side Dynamic Iterative Game Theory of Many Phases in EIA
Hongguang Cheng, Xiao Pu, Dan Wang, Li Gong

472. Application of Multi-Objective Evaluation on Selecting the Program Project - A Case in Environment Impact Assessment of Dianzhong Delivery Water Project
Hongguang Cheng, Dan Wang, Li Gong

Concurrent Sessions

636. The Environmental Evaluation Method of Coastal Land Reclamation: Case Study of Korea
Sung-Soon Yoon, Jin-Sook Yoon, Chul-Oh Shin, Myung-Gook Jeoung

743. Quantifying Cumulative Impact Assessment with Dynamic Computational G.I.S. System in a Multi-Stressor Area: A Case Study on a Waste Treatment Plant in Italy
Giuseppe Magro, Leonardo Marotta

CS24.2 Sustainable Development: Sustainable Development in Africa II

Room: 321C
Chair: C.P. Wolf

506. Impact Assessment, Environmental Conservation and the Sustainable Development of Petroleum Resources in the Endangered Nigerian Delta Region
Edward Bristol-Alagbariya

748. Sustainable Development in Environmental Impact Assessment of Road Projects: State of Practice and Future Trends in Africa
Jean-Philippe Waaub, Djibo Boubacar, Marguerite Wotto

405. Economic Growth vs. Environmental Protection
Segaetsho Shado Ramahobo

CS4.3 Climate Change: Climate Change in Urban Areas

Room: 330B
Chair: Wha-jin Han

408. Does the Restoration of an Inner-City Stream in Seoul Affect Local Climate?
Yeon-Hee Kim, Jong-Jin Baik, Hae-Jung Koo, Kyu Rang Kim, Byoung-Cheol Choi

437. The Promotion of Environmental Assessments Concerning Urban Climate and Air Quality in Spatial/Land Use Planning in Seoul, Republic of Korea
Jeong-Hee Eum, Johann Köppel, Dieter Scherer, Ute Fehrenbach

458. Global Warming, Urbanization, and Heat Waves
Byoung-Cheol Choi, Jiyoung Kim, Dae-Geun Lee

573. Radiative Impacts of Urban Aerosols in Seoul, Korea
Jiyoung Kim, Byoung-Cheol Choi

570. Building Wind Impact Assessment of Skyscrapers in Seoul, Korea
Nahm-Joo Hur, Kyoo-seock Lee

771. Evaluating Microclimatic Impact Assessment of High-Rise Buildings in Korea
Jae-cheol Kim, Eun-Soo Chahng, Kyoo-seock Lee

CS23.2 Strategic Environmental Assessment: SEA in Vietnam: Recent Progress and Future Challenges

Room: 330C
Chairs: Nguyen Khac Kinh, Jiri Dusik, Harald Lossack

21. SEA in Vietnam: Recent Progress and Future Challenges
Axel Olearius, Khac Kinh Nguyen, André Lova, Nam Le Hoai, Pham Ngoc Dang

SEA in Vietnam: Development of a Legal System and a Framework for Capacity Building
Nguyen Khac Kinh

Hydropower Planning and Sustainability: SEA of Hydropower Plans for the Vu Gia - Thu Bon River Basin in Vietnam
Jiri Dusik

SEA of Spatial and Sector Plan at Regional and Provincial Level in Vietnam: Outcomes and Lessons Learned
Le Hoai Nam, Niels Juul Busch

SEA of the Vinh Phuc Socio-Economic Development Plan in Vietnam: Outcomes and Lessons Learned
Bruce Dunn, Axel Olearius, Herbert Christ

Linking SEA and City Development Strategy in Vietnam
Maria Partidario, Dao Minh Chau, Nguyen Van Duyen

476. Linking SEA and City Development Strategy in Vietnam
Maria Partidario, Michael Paddon, Dao Minh Chau, Nguyen van Duyen, Markus Eggenberger

CS19.2 Land Use Planning, Transportation, Landscape: Land Use in Government

Room: 323
Chair: Myung-Woo Lee

230. Non-Land Use Planning in Sub-Saharan Africa: Kenya - Solutions and Incentives to Government Responsibility
Sarah Macharia

285. When the Urban Environment Encroaches on State-Managed Land: How Does the State Balance Interests?
Cynthia Pratt

321. Strategic Guidelines for the Integrated Development of Valdaso (Aso Valley) (Ascoli Piceno) - Marche - Italia
Virginio Bettini, Marco Stevanin, Pippo Gianoni, Marco Abordi, Federica Marangoni, Fabrizio Torresi

382. Marbled Murrelet Initiative: Land Use Challenges Amending a Federal Habitat Conservation Plan
Cynthia Pratt

Thursday, 7 June

14:30-16:00

CS16.5 Impact Assessment in Asia: Asian SEA, EIA and Sustainability Assessment-Asian EIA Cases in Water Sector

Room: 320A
Chair: Kii Hayashi, Young-Il Song

473. Evaluation of Effect of TMDL on Local Government
MyoungSoon Bae, SungRyong Ha, EulRyul Ryu

673. Marine and Social Impacts by Large-scale Reclamation of Coastal Wetlands in Korea
Keunhyung Yook, Jungho Nam

683. Impact Assessment of Urban Wetlands in the Western Province of Sri Lanka
Kalyanaratne Attanayake, Nilmini Attanayake

CS23.1.5 SEA: Methodological Aspects

Room: 320B
Chair: Sang Eun Lee

381. Improving Data Usability for Effective Environmental Indicators in Strategic Environmental Assessment
Peter Mooney, Alison Donnelly

415. Challenges in the Development of Landscape Indicators for Local Authority SEA Reporting
Lianda d'Auria

586. Cumulative Effects Considerations in Strategic Environmental Assessment
Bram Noble, Jill Harriman

687. Multi-Stage Environmental Impact Assessment on Processing for Toxic Wastes Abandoned Illegally
Masaru Ito

756. The Introduction of Alternative Environmental Assessment Model: APEMI IA Model
Im Soon Kim, Joo Hyun Park, Sang Wook Han, Young Han Han, Suk Ho Lee, Duk Woo Kim

CS8.1.7 EIA Methodologies and Practice

Room: 320C
Chair: Kyoo-Seock Lee

404. EIA: Web-Based Tools for a Participatory Approach
Kurt Fedra

713. Geographical Barrier Mapping
Ji Young Kim

717. A Web-Based Expert System of East River Watershed in Korea for Conservation of Ecology and Environment
Joon Hyun Kim, Natalia Yakunina, Doo San Choi

721. GIS-Based Assessment of Carrying Capacity and Spatio-Temporal Visitor Management for National Parks: Focusing on the Mt. Chiri National Park in Korea
Min-Ho Son, Woo-Kyun Lee

CS7 Disaster and Conflicts

Room: 311
Chair: Michel A. Bouchard

424. Environmental Impact Assessment in Peacekeeping Missions - Challenges and Opportunities
Birgitta Liljedahl, Annica Waleij, Svante Olsson, Russ Doran

429. From Policies to Practice - Environmental Support to Peacekeeping Operations
Annica Waleij, Gabriele Borla, Birgitta Liljedahl

590. The Impact on Woodland of Refugee Camp in Kigoma Region, Western Tanzania
Joseph Kihale

699. EIA Tools for Extreme Environments: Current Coverage and Gaps Remaining
Charles Kelly

CS8.1.9 EIA Methodologies and Practice

Room: 310
Chair: Seokho Lee

655. Compensation Integrated into Infrastructure Planning and EIA in Finland, Case: Europe E18 Motorway Turku-Vaalimaa
Tiina Kähkö

704. SEA Guideline of Road Planning
Mu Choon Lee, Kong Jang Cho

Concurrent Sessions

337. Longitudinal Assessment of the Social Impacts of the Coppabella Coal Mine, Queensland, Australia

John Rolfe, Galina Ivanova, Stewart Lockie

715. The Study of the Integrated Evaluation and Management System for the Artificial Ground Greening in Urban Area in Korea
Dong-kun Lee, So-won Yoon, Seung-hwan Oh, Seong-wan Jang

645. Supporting South Africa's Economic Development through the Evaluation and Improvement of Environmental Assessment Tools

Brent Johnson, Doug Trotter

CS2.4 Biodiversity and Ecology: Integrating Biodiversity in Impact Assessment for Strengthening Resource Conservation: Mainstreaming Tools, Methods, and Case Studies

Room: 330A
Chair: Tae Ho Ro

214. Ecological Function Districts and Their Eco-Construction in River Corridor in the Middle and Lower Reaches of Tarim River
Huarong Zhou, Duning Xiao

544. Model Selection for Predictive Species Range Mapping
Changwan Seo, James Thorne, David Stoms, Wilfried Thullier, Frank Davis, Lee Hannah

170. Impact of Income on Household Energy Use Patterns in Botswana: Implications for Economic Growth and Forest Biodiversity Conservation
Charity Kerapletswe

CS20.5 Public Participation: Discussion on Cooperation and Stakeholder Participation in Transportation and Infrastructure Planning

Room: 304A
Chair: Jos Arts

530. Stakeholder Participation in the Road Planning and EIA Process: The Case N18/ Achterhoek in the Netherlands
Jan Nuesink, Luis Martins Dias, Christa Kempenaar, Benno Bultink

531. Stakeholder Participation in the Road Planning and EIA Process: The Case E22/ Eastern Entrance to Riga in Latvia
Jan Nuesink, Luis Martins Dias, Christa Kempenaar, Benno Bultink

CS22.5 Social Impact Assessment: SIA in a Pan-Asian Context

Room: 304B
Chair: Mary Tapsell

399. The Effectiveness of Social Variables in Social Impact Assessment: The Korean Case
Juchul Jung, Jaeyoung Lim

483. A Methodological Issue in Post-Project Assessment of Social Impact: Case Study of Involuntary Resettlement Caused by Dam Construction in Japan
Naruhiko Takesada

677. Assessing the Economic Benefit of Natural Preservation from Marine Protected Area: A Case Study of Saeng-Do Island, Busan
Chul-Oh Shin, Won-Keun Chang

750. Social Impact Assessment of the Limestone Mining Industries in Local Communities of Korea

Young Chul Shin

396. Post-Project Review on Resettlement Scheme Applied for a Dam Construction Project in Indonesia
Syafruddin Karimi, Mikiyasu Nakayama, Ryo Fujikura

554. Socioeconomic Impact of Designating a Marine Protected Area in Korea
Won Keun Chang

CS14.1 Governance

Room: 307
Chair: Jong-Gwan Jung

292. Social Impact Assessment of Technology Use for Good Governance in Bangladesh: Prospect of Learning from the Newly Industrialized Asian Economies
Md. Khalid Hossain

397. Knowledge Integration Approach for Sustainability Policy
Dongwon Shin

600. The Appraisal of Growth and Conservation in Promoting Corporate Governance of Sustainability
Jokotade Folasade Odekunle

778. The Big Picture View: Using Conceptual Impact Models to Identify, Communicate and Provide Clarity on Important Issues
Lorne Greig, Kim Pawley

CS1.1 Agriculture, Forestry and Fisheries Session 1

Room: 308
Chair: Mark Curtis

329. Strategic Environment Assessment of National Water Plan of Nepal
Ram Khadka

384. Assessing the Social Impacts of Changes in Fisheries Policy: A Review of Recent Australian Experience
Jacki Schirmer

419. Growth, Conservation and Responsibility: Promoting Good Governance and Corporate Stewardship through Impact Assessment - Niger Delta Experience
David Nwiisator, E.A. Emerhi Bukola, A. Oyebade, C.P. Wolf

562. Mountains-Scale Forest Fragmentation Delineation Using Multi-Temporal Trends in Remote Sensing-Derived Land Cover Classification
Gab-Sue Jang, Jong-Gwan Jung, In-Hwan Park

686. Deforestation Patterns Analysis of the Baekdudaegan Mountain Range, Korea
Won-kyong Song, Dong-kun Lee

CS15.8 Health Impact Assessment: HIA and Community Empowerment

Room: 321A
Chair: Roy Kwiatkowski

435. Community Empowerment in Health Impact Assessment
Roy Kwiatkowski

354. Learning for Our Beloved River: HIA Applications in The Chin River
Prachoen Kontes

203. Health Impact Assessment: An Under-served Miami, Florida, Community Embraces the Future and Preserves the Past
Luther Brewster, David Brown

726. Community Participation in Health Impact Assessment: A Case Study of a Proposed Extension to an Opencast Coal Mine, Wales UK

Alison Golby

CS8.1.5 EIA Methodologies & Practice

Room: 321B
Chair: Deok-Gil Rhee

335. Assessing Community Views about Mining Town Developments Using the Choice Modelling Technique
Stewart Lockie, John Rolfe, Galina Ivanova

736. Development of Prior Environmental Review Support System in Korea
Eui Sung Jung, Jeong-Ho Yoon, Jeongho Lee, ByungHwa Lee, YongHwan Kim, Won-Seok Lee

640. Comparison of Post-Monitoring of EIA in Korea with UNEP EIA Training Resource Manual
Choon-won Lee, Sang-don Lee, Sung-hyun Yoon, Sang-wook Han, Sun-hong Kang

777. The Changing Roles of Environmental Practitioners in Uganda
Anita Kigonya

CS24.3 Sustainable Development Environmental Information Technology: Sustainable Development in Asia

Room: 321C
Chair: Sang-Hoon Lee

236. How Impact Assessment Is Needed in Sustainable Development in Nepal (Mixed View)
Dipak Adhikari

543. An Integrated Operation of Multi-Regional Water Supply Networks for an Optimal Water Allocation in a Metropolitan
Taesang Ryu, Sung-Ryong Ha, Ik-Hwan Ko

596. A New Decision Making Process for Environment Friendly Resort Development - Case Study on Alpensia Resort Development Project
Se-Hoon Park, Gyoung-Sook Lee, Hoi-Seong Jeong, Young-Shin Lee

707. Movement of Eco-Village for ESSD in Korea
Won Jin Oh, Jong Ho Lee

769. Energy and Environment: Examples of Power Generation in Korea
Jong-Han Jung, Sang-Ki Chun

CS11.2 Environmental Information Technology

Room: 330B
Chair: Jung-Sup Um

517. Soil Contamination in Korean Agricultural Farmlands Being at a Reachable Distance from Heavy Metal Sources
Sung Ryong Ha, Jae Seok Hwang

430. Transport Canada National Environmental Assessment Tracking System: An Integrated Information Management System
Hugo Gherbavaz

716. A Web-Based Partial Differential Equation Solver as a General Modeling System for Environmental Problems
Joon Hyun Kim, Young Han Han, Doo San Choi

694. Comprehensive Environment Information Management System
Joon Hyun Kim

Concurrent Sessions

CS23.4 Strategic Environmental Assessment: Greening Poverty Reduction Strategy of Benin

Room: 330C
Chairs: Bonaventure Guedegbe, Linda Ghanimé, Harald Lossack

Greening PRSPs and MDG-Based Approaches: Overall Context

Linda Ghanimé, Harald Lossack

The Benin Greening Process: Design and Outcomes

Bonaventure Guedegbe

Perspectives from Principles of Paris Declaration on Aid Effectiveness: SEA Alignment and Donor Harmonisation

Johan Brons, Axel Olearius

Comparison of Country Perspectives and Institutional Challenges

Marcel Baglo

Welcome to IAIA

Room: 323
Chair: Rita Hamm

Any member who wants to know more about the organization, its history, and how it works; new or prospective Board members; or anyone interested in participating in IAIA as a Committee member of Section member is invited to attend this information session.

Thursday, 7 June

16:30-18:00

CS23.1.6 Strategic Environmental Assessment: Case Studies

Room: 320B
Chair: Sang Wook Han, Seokho Lee

331. Application of SEA in the Process of Chungnam Provincial Planning

Jong-Gwan Jung, Sang-Wook Han

383. Lessons from the São Paulo-Brazil Ringroad Strategic Environmental Assessment

Carlos Henrique Aranha, Paulo Tromboni Nascimento, Maria Rosário Partidário

455. Preliminary Study of Strategic Environmental Assessment with Fish Investigation for Dam Construction Long-Term Plan

Jinwon Seo, Jungmin Lee, Sungwoo Lee

10. Strategic Environmental Assessment for Urban Development Plan in China: A Case study from Wu Han Municipal

He Xu, Li li Tian, Jing Wu

CS23.5 Challenges and Opportunities in Impact Assessment: Oil Sands Development in Alberta, Canada (Panel)

Room: 320C
Chairs: Peter Sylvester, Scott Streiner

Oil sands development has been examined through both project-specific assessments and, most recently, though a more strategic, multi-stakeholder process involving industry, local communities, environmental NGOs, aboriginal peoples, and the provincial and federal governments. The panel includes representatives of these different stakeholders. Each participant brings a unique perspective to evaluating the assessment approaches being applied to oil sands development with a view to identifying best practices, consistent with the conference theme of promoting good governance and stewardship through effective impact assessment.

CS21 Restoration

Room: 311
Chair: Eun-Shik Kim

226. Reclamation and Closure of Coal Mines: Implications to Develop a National Strategy for Reclamation of Coal Mines in South Africa

Aubrey Tshivhandekano

348. Restoration and Monitoring of Endangered Fish, Black Shinner (*Pseudopungtungia nigra*) in the Upper Reach of Gap Stream

Jinwon Seo

498. Halophyte Restoration: Effects of Small Groins for Enhancement of a Salt-Marsh Plant Community in the Western Coast of Korea

Jinho Chae, Seung Ho Lee, Hansan Park, Jeom-Sook Lee

698. A Study on A/R CDM Application of Deforested Land in North Korea

Young-Chool Oh, Dong-Kun Lee, Jae-Uk Kim

245. Critique of Protected Areas' Strategy Regarding Rural Communities for the Conservation of Living Resources in the South African Context

Qondile Paliso

727. Economic Development vs. Conservation - The Okoroba FDP Experience

Leo Asuquo

CS8.2 EIA Methodologies and Practice: Economic Implications on Effectiveness of EIA - A Case Study of Kenya (Roundtable)

Room: 310
Chair: James Kambo

This roundtable will analyze and debate the workability and effectiveness of EIA in light of economic capacities of a state or region. EIAs require financial resources to undertake, review and monitor. What therefore are the implications where a country strives to develop but has limited financial resources both within the public and private sector? The experiences from Kenya point at low economic capacities resulting in reduced capacities to perform environmental assessments and enforce environmental compliance. The gist of this session is to discuss viable but effective means of attaining sustainable development and environmental compliance in developing countries. Interested participants are invited to attend in the discussion and share experiences and knowledge.

CS2.5 Biodiversity and Ecology: Growth, Biodiversity Conservation and Sustainable Development: The Pan-Asian Perspective

Room: 330A
Chair: Vinod B. Mathur

563. Establishment of Park and Green Areas for the Development Projects of Residential Areas

Sang-Don Lee, Sung-ok Kim

589. Lotic Community Prediction Model Responding Environmental Change (LOCO-PEM)

Tae Ho Ro, Dong Jun Chun

611. Establishing a Conservation Area by Habitat and Landscape Matrix Analysis

Eun Joo Yoon, Dong Kun Lee

CS20.6 Public Participation: Public Participation Africa and Asia

Room: 304A
Chair: Loes Witteveen

263. Gender Issues in the Participatory Approach to Resource Management for Water Supply and Sanitation in Ghana

Richmond Amoako, Seth Larmie, Regina Aikins

627. Current Status of Public Participation in the EIA Process in China

Xinfeng Zhao

669. Strengthening Public Participation in Decision-Making Process for Balancing Coastal Development and Environmental Revitalization in Korea

Jungho Nam, Wonkeun Chang, Jisun Lee

CS22.6 Social Impact Assessment: Involving Communities in Impact Assessment (Panel)

Room: 304B
Chair: Ilse Aucamp

Increasingly, awareness of the importance of participatory environmental processes is rising. Without buy-in of communities, conservation efforts can be futile. SIA as a participatory and empowerment process and its links to other environmental tools and biodiversity will be debated.

CS14.2 Governance: Session 2

Room: 307
Chair: Jae-Seok Yun

350. Comparing Institutions: The Tennessee Valley Authority and the Niger Delta Development Commission

C. P. Wolf, Christian Ayasuk

453. Effect Analysis of the Industrial Policy of Shandong Province

Ren Lijun, Wang Jianchun, Yuan Cunchao

714. Local Environmental Action Programme (LEAP) Successful SEA for Local Planning

Arend Kolhoff, Petrie van Gent

CS1.2 Agriculture, Forestry and Fisheries: Session 2

Room: 308
Chair: Michael Koech

- 134. Water Resource Variability and Livelihoods in the Lower Rufiji Wetland Ecosystems (Tanzania)**
Augustino Mwakipesile
- 158. Impact Assessment of Kenya's Biodiversity and Agriculture: Contributions of Meteorological Services**
Michael Koech
- 243. Impact Assessment in Rural Development Planning: A Case Study of Nansanga Farm Brock Development in Serenje District of Zambia**
Mackion Tembo
- 286. Environmental Impact Assessment in the Booming Floriculture Industry of Ethiopia**
Asferachew Abate
- 360. Changed Environment - Impact on Livelihoods**
Anna Axelsson

CS15.9 Health Impact Assessment: Key Issues in HIA Practice (Roundtable)

Room: 321A
Chair: Ben Harris-Roxas

This session will draw on practitioner experiences to discuss key issues facing HIA practice. Scenarios will be presented for discussion, drawn from practitioners' actual experiences in undertaking HIAs. Topics for discussion will include:

- How to integrate HIA with other forms of assessment in practice
- How to promote robust follow-up and monitoring of health impacts in practice
- How to meaningfully engage communities in HIAs
- Managing trans-boundary issues in HIA
- Practical facilitators and barriers in HIA: what works and what doesn't

Participants are invited to share their views throughout the session.

CS8.1.6 EIA Methodologies and Practice: Session 6

Room: 321B
Chair: Jaeyong Choi

- 641. EIA as Planning Tool and Its Effectiveness in Rwanda**
Theobald Mashinga
- 648. Overview of Independent Oversight Agencies**
Bill Ross
- 733. EA System in Russia: Latest Changes and Tendencies**
Marina Khotuleva, Tatiana Strizhova, Vladimir Chechetkin
- 738. Impact Assessment in Italy: An Overview on Regulation, Policy and Perspective**
Giuseppe Magro, Virginio Bettini, Marco Sumini, Chiara Rosnati

CS11.3 Environmental Information Technology: Session 3

Room: 330B
Chair: Joon Hyun Kim

- 525. Application of HyGIS-QUAL2E: A User-Friendly Coupled QUAL2E Model with Korean Hydrological GIS Package, HyGIS**
Sung-Ryong Ha, In-Hyeok Park
- 522. Identify a Pollution Delivery Coefficient for a Stream Water Quality Analysis Model Introducing a Watershed Form Ratio**
Sung-Ryong Ha, Jung-Ha Park
- 401. Assessment of Urban and Industrial Air Quality: A Real-Time Web-Based Approach**
Kurt Fedra, Tai J. Kim
- 740. Quantifying Impact Assessment with G.I.S. Systems: A New Methodology**
Giuseppe Magro, Marco Sumini, Stefania Pellegrini, Stefano Scarpanti, Francesco Teodori

CS19.3 Land Use Planning, Transportation, Landscape Environmental Information Technology: Landscape and Space

Room: 323
Chair: Juchul Jung

- 324. Economical Growth and Impact Assessment in the Building Sector: Improving the Knowledge of Input and Output Material Flows During the Life Cycle of Buildings**
Claudia Salazar, Jacques Chevalier, Patrick Rousseaux
- 423. Analysis and Simulation of Landscape Change in Dianchi Area, China**
Hongguang Cheng, Dan Wang, Li Gong, Xiao Pu
- 690. Landscape Ecological Assessment of the New Urban Development on Regional Landscape Connectivity**
Sangbum Lee
- 719. Assessing the Spatial Dimension of Sustainability in Ho Chi Minh City**
Harry Storch
- 403. Post Evaluation on the Biological Habitat and the Human Using Structures after Natural Restoration of Jeonju-cheon, South Korea**
Myung-woo Lee, Jong-young Park, Mu-sup Beon

Notes

Posters

- 112. Balancing Energy Production, Biodiversity, and Ecosystem for Hydropower Production – A Case Study Lower Kihansi Hydropower Project (LKHP) in Tanzania East Africa**
Hamdun Rashid Mansur
- 146. The Results of Strategies to Mitigate Environmental Impacts Caused By Light Pollution in the Conservation of Sea Turtles in Brazil**
Victor Patiri, Sandra Ferreira, Gustave Lopez, Elizabete Domingos
- 205. The EIA as a Tool of Local Development**
Ernesto Pirillo
- 251. Economic and Environmental Impacts of Rural Electrification Using Household Photovoltaic Systems in Brazil**
Hugo Machado, Sandra Neusa Marchesini Ferreira, Antônio Augusto Costa De Assis
- 253. Economic Valuation of Health Effects Within Health Impact Assessments (HIA)**
Julia Nowacki, Rainer Fehr
- 279. The Benefits of Social Impact Assessment for the Environmental Impact Assessment Process**
Rabel Burdge
- 294. EIA of New Motorways in Croatia: Two Case Studies**
Anita Erdelez
- 299. Alternatives in High Voltage Substation Project EIAs: One Engineering Approach**
Bora Obradovic
- 311. Possibilities of Strengthening of EIA Process by EMS and Vice Versa**
Andrej Ursic, Simona Ursic, Borut Mlakar
- 314. For an Effective Follow-Up Process In Korean EIA**
Yongjun Joo, Junho Maeng, Kwangwoo Cho
- 315. Improving EIA System for Harbor Developments in Korea**
Junho Maeng, Kwangwoo Cho, Yongjun Joo
- 320. Promotion Of EA Education for Third Country Audience**
Paola Gazzola, Ingrid Belcakova, Urmila Jha Thakur, Ralf Aschemann, Thomas B Fischer,
- 322. Impacts of GTZ/InWent Training on SEA**
Axel Olearius, Harald Lossack
- 334. Development of HIA in Republic of Slovenia**
Simona Ursic, Andrej Ursic
- 340. Gostima SHPP**
Besim Islami, Hysni Laçi
- 343. Pollution: Think Before Problems Show Up**
Elona Vathi
- 351. Grazing Impact of Zooplankton on Phytoplankton in the Heavily Polluted Coastal Waters and Its Application as a Tool of Marine Environmental Impact Assessment**
Seongtaek Kim, Younggeel Kim, Jinho Chae, Jiwang Lee, Junho Maeng, Kwangwoo Cho
- 357. Influence of Island City (Artificial Island) on the Water of Head of Hakata Bay, Fukuoka, Japan**
Masaioiro Babasaki
- 390. Heat Wave and Its Health Impact in Korea**
Dae-Geun Lee, Jiyoung Kim, Byoung-Cheol Choi
- 392. Improving Korean EIA Related to Military Facilities**
Joon-Gyu Choi, Jae-Gu Kang, Young-Joon Joo, Kong-Jang Cho
- 393. Lead Contamination from Target Shooting in Washington State (USA) and Belarus: Similar Problems and Possible Resolution**
Alla Sushko
- 421. Development of the Gyeongsangnam-Do Wetland Information System Based on Web GIS**
Kyung-Hun Park, Sung-Gwan Jung, Jun-Han You, Do-Gyun Kwon, Kyung-Tae Kim, Woo-Sung Lee
- 441. Light-Response of Krill, *Euphausia Pacifica*, and Its Application to a Preventive Measure of the Mass Impingement to Cooling-Water Intakes of Power Plants with Remarks on Their Diel Vertical Migration and Ontogenic Migration**
Jinho Chae, Jae-Hac Lee
- 457. Environmental Consideration of Small Hydropower (SHP) Plant Construction**
Dong Jun Chun, Young Han Kwon, Ji Young Kim, Tae Ho Ro
- 459. Analysis of Ecological Characteristics about Major Estuaries in Korea Based on the Aquatic Insect Assembles**
Dong Jun Chun, Tae Ho Ro
- 461. A Study on the GIS-Based Environmental Impact Evaluation for Route Alignment**
Mi Ran Park, Sang Eun Lee, Yu Kyung Choi, Ho Geun Kang, Han Na Choi, Jae Hee Lee
- 478. A Study on Establishment of the Directions for Environmentally-Friendly Restoration of Stream by Citizens**
Byung Seol Byun, Se Ah Ahn, Kyu Man Cho
- 485. A Study on the Making of Suwon Hwaseong, A World Heritage Site, into a Holy Place**
Byung Seol Byun, Kyu Man Cho, Se Ah Ahn
- 488. Dangsang Forest as an Environmental Factor for Coast Areas in Korea**
Jai-Ung Choi, Dong-Yeob Kim
- 501. HIA in National Health Act, B.C.2550, Thailand**
Amphon Jindawattana, Ugrid Milintangkul, Kannikar Bunteongjit, Pitiporn Chandrtat, Nirachara Ussavathirakul, Somporn Pengkam
- 503. Establishment of an Assessment System for Environment-Friendly Performance of Residential Land Development Project**
In-Su Jung, Hyun-Su Park, Chan-Sik Lee
- 523. Trends in Corporate Sustainability Reporting: Deeds Not Words?**
Angela Pinilla Urzola
- 534. The Dutch Partners for Roads Programme and EIA/Transportation Centre: Exchange of Know-How and Enhancing Quality in Infrastructure Planning**
Luis Martins Dias, Jan Nuesink, Benno Bultink, Christa Kempenaar
- 536. Stakeholder Involvement and Public Participation in the Road Planning Process: European Examples Derived from the Dutch Partners for Roads Programme**
Luis Martins Dias, Jan Nuesink, Christa Kempenaar, Benno Bultink
- 559. Assessment of Air Pollution Emission Control Strategy Using Linear Programming Technique**
Young-Kee Jang, Sang Hoon Lee, Jung Kim
- 560. Analysis and Prediction of Water Quality Variation in Flow Line of Gwangju Stream**
Nam-In Jung, Yong-Woon Lee, Won-Mo Yang, Se-Jong Yoon, Jae-Choon Lee, Won-Sam Jeong
- 580. Integration of Environmental, Social and Economic Indicators for Land Use Assessment**
Birthe Schoesser, Katharina Helming, Marta Perez-Soba, Pia Frederikson, Karen Tscherning, Bettina Koenig
- 581. EIA and SEA Capacity Building In Developing Countries**
Helena Lindemark
- 583. EIA and SEA Training Programmes**
Helena Lindemark

- 588. Water Quality and Contamination of Transboundary Watershed in Northern Mongolia**
Young-Joon Lee, Seong-Taek Yun, Jeongho Lee, Mendbayar Badarch
- 599. Distribution and Changing Trend on the Occurrence of the Kot-Saem Chui**
Jiyoun Kim, Seungho Lee, Young-Ah Kwon
- 604. Reduced Premature Deaths From Attaining the 8-Hr Ozone Standard in Seoul, Korea**
Myung-Hyun Kim, Hyunjoo Bae, Jongsik Ha, Jeongim Park
- 605. Concepts and Case Studies of National Environmental Assessment Map in Korea**
Seong-Woo Jeon, Chong-Soo Lee, Moungh-Jin Lee, Hyun-Jung Hong, Byung-Jin Kang,
- 609. Heat-Related Mortality Among the Elderly in Seoul From 1994 To 2003**
Jongsik Ha, Ho Kim, Jeongim Park
- 610. Study on Application of Environmental Impact in Railroad Work**
Hyosung Sun, Sangki Choi, Youngmin Park
- 613. Korean Emission Inventory Processing for Air Quality Assessment**
Nankyoun Moon, Soontae Kim
- 615. The Solutions for Aesthetic Water Quality Improvement of Drinking Water In Korea**
Soon-Ju Yu, Jun-Hwan Kim, Su-Jeong Park, Il-Rok Chung, Kyung-Hee Ahn, Yeon-Hee Lee
- 617. Prioritization of Watershed Restoration Proposals Using Rapid Impact Assessment Matrix**
Markku Kuitunen, Tiina Shakib-Manesh, Kimmo Hirvonen, Kimmo Jalava
- 619. Reclaiming Conservation in Developing Countries Through Sustainable Waste Management**
Irene Amoke, Jandi Kim
- 630. An Assessment of Environmental Capacity of Jinhae City Using Ecological Footprint**
Kyung-Tae Kim, Sung-Gwan Jung, Kyung-Hun Park, Ju-Han You, Woo-Sung Lee,
- 635. The Application of Integrated Assessment System for Urban Sustainable Development**
Woo Sung Lee, Sung Gwan Jung, Kyung Hun Park, Ju Han You, Kyung Tae Kim,
- 637. Mangrove Re-Vegetation in Shell Nigeria 1996 - 2006**
Oritsetimeyin Dada
- 649. Application of Index of Greenness in Streetscape on the Environmental Impact Assessment of Seoul**
Yong-Hyeon Cho
- 650. Health Impacts of Economic Cycling: Implications for HIA in Resource-Based Economies**
Murray Lee, Marla Orenstein
- 654. Applications of Biotope Area Factor on the Environmental Impact Assessment of Seoul**
Yong-Hyeon Cho
- 657. Capacity Development Through Knowledge Sharing**
Petrie Van Gent
- 661. Indicator Species for Climate Change Impact Assessment on Korean Peninsula**
Tae Kyu Kim, Kee Dae Kim, Myung Hun Yeon, Jae Ho Lee, Min Hwan Suh, Young Kyu Shin
- 676. Environmental Eco-Plan of Developing Multi-Functional Administrative City in Korea**
Youngsook Lee, Heonseok Yoo
- 679. Assessment of Pollutant Accumulation and Washoff Potential on an Urban Area**
Sangyoung Park, Sungryong Ha
- 681. Assessment of Groundwater Pollution and Water Quality Susceptibility Using GIS-Based Drastic and MT3D**
Daehee Park, Sangyoung Park, Sungryong Ha
- 705. High-Efficiency Constructed Wetland Using NPS in Cambodia**
Kyoungyoung Choi, Jiyoun Kim
- 709. Sustainable Siting of Golf Courses in Mountainous Area in Korea**
Young Han Kwon, Ji Young Kim
- 718. Optimum Slope Analysis Method**
Ji Young Kim
- 722. Socioeconomic Effects on PM10 Related Mortality in Seoul, Korea**
Hyunjoo Bae, Jeongim Park
- 725. Comparative Matrix of Environmental Assessment in Latin America**
Ernesto Sanchez-Triana, Santiago Enriquez
- 739. Impact Assessment as Part of Integrated Planning and Management of Tourism in and Around Natural Areas**
Nick Taylor, Janet Gough, Julie Warren, Paul Blaschke, Marc Bailly
- 751. Lessons from Massive Outbreak of Fly and Midge at Landfill Site**
Jong Min Kim, Won Myeong Kim, Kang Suk Koh, Ki Kyeong Kim
- 753. Invasion of Alien Plant into Nature Reserve Area in Korea**
Ji Hyon Kil, Won Hee Kim, Hyun Chul Shin, Jong Min Kim
- 754. Abandoned *Brassica Napus* Occupied Part of Yongsan River Bed**
Jong Min Kim, Jong Whan Park
- 755. Water Stream Basically Determined *Sicyos Angulata* Spread in Korea**
Jong Min Kim, Ji Hyon Kil, Hak Yang Kong
- 757. Long-Term Monitoring of Aquatic Environmental Changes During Dam (Yongdam) Construction Project**
Jae-Ki Shin, Hye Keun Lee, Ick Hwan Ko
- 758. Rapid Trophic Classification of Streams Based on Microalgae Biomass in Strategic Environmental Assessment**
Jae-Ki Shin, Hye Keun Lee, Ick Hwan Ko
- 759. Prediction of Reservoir Water Quality Before Dam Construction Using Algal Growth Potential Test (AGPT)**
Jae-Ki Shin, Hye Keun Lee, Ick Hwan Ko
- 761. Ecological Impact Evaluation in the Downstream of Regulated River System**
Jae-Ki Shin, Hye Keun Lee, Ick Hwan Ko
- 762. Municipal Training, EIA**
Carmen Elena Padilla-Velasco
- 765. "Winds of Change" - A Look at Wind Farm Land Owner Agreements**
Rick Grabowecy
- 785. Role of SEA in Post-Tsunami Reconstruction in the Maldives**
Aslam Shakir, Richard Morgan
- 786. The State of AEE Guidance Material Provided to Resource Consent Applicants by Local, Regional and Central Government in New Zealand**
Ben Varkalis

Exhibitors/Map: Seoul

Exhibits, posters, information tables and more are located in the Conference Center Lobby.

Booths

- **Korea Water Resources**
- **Edward Elgar Publishing**
- **IAIA08**

Tables

- **Rabel Burdge**
- **Ben Harris-Roxas**
- **International Finance Corporation**
- **Capacity Building in Biodiversity and Impact Assessment**

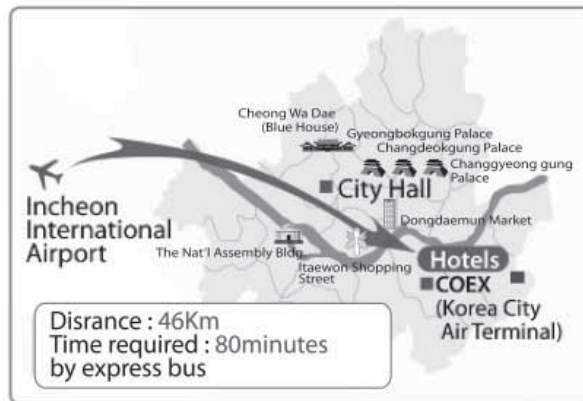

COEX Convention Center and Surrounding Area

Conference Hotels

1. COEX International Seoul
159, Samsung-dong Kangnam-Ku
+82-2-3452 2500
2. Ramada Hotel Seoul
112-5, Samsung-Dong, Kangnam-Gu
+822 6202 2000
3. Hotel Riviera
53-7 Cheongdam-dong Gangnam-gu
+82 2 541 3111
4. IBIS Ambassador Seoul
893-1 Daechi-dong Gangnam-Gu
+82 0 2 3011 8888
5. Provista
#1677-8 Seocho-1dong, Seocho-gu
+82 2 597 1140
6. Co-op Residence - Samsung
945-29, Daechi-dong, Kangnam-gu
+82 2 539 9080

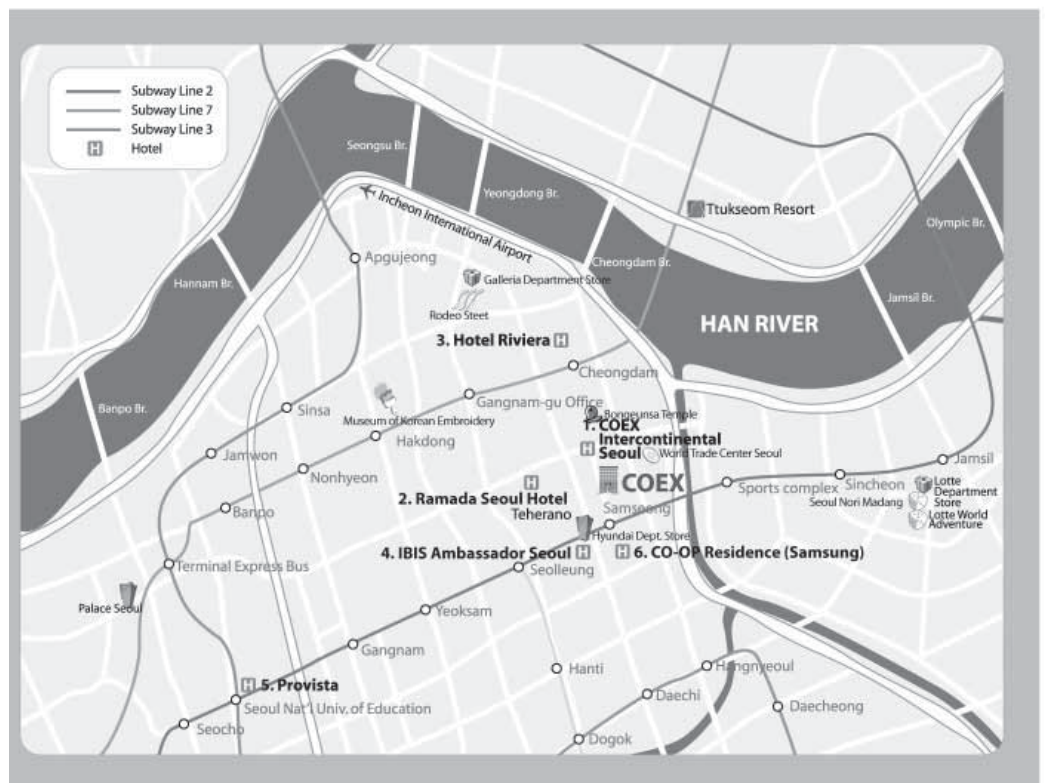

About Technical Visits

Participants must be pre-registered and pre-paid to participate. Registrations will be accepted on a first-come, first-served basis until the visits reach the maximum number. Registrations will be processed in the order that payment is received. No refunds are issued for cancellations after 31 March.

Technical visits will depart from COEX. Please meet at the IAIA registration desk a minimum of 20 minutes prior to the start time of the technical visit.

- Family members of registered delegates are welcome to register for technical visits.
- Casual clothing and walking shoes are recommended.

A Cheonggyecheon (Stream Restoration)

The restoration of Cheonggyecheon, a stream which crosses the heart of Seoul for 6 kilometers, took about three years and was completed in early 2006 under the keen watch of the entire nation. It was a symbolic project to revive an important piece of Korea's historical and natural heritage at the start of the twentieth century.

Since the Korean War, the Cheonggyecheon Stream area became a shantytown because of pollution and decimated surroundings. In the 1960s and 1970s, slums were cleared for elevated expressways and commercial facilities. However, as time passed, dust and emissions from traffic on the roads and overpasses polluted the covered stream and corroded the roadway infrastructure, posing a threat to public safety. After the restoration of Cheonggyecheon, the place where traffic jams and overpasses seemed eternally to drag the heart of city down no longer exists. The use of public transportation has increased and the level of pollution has decreased. Most important of all, it has become a popular place where citizens of Seoul gather and enjoy the promenade.

This tour will focus on how the restoration of Cheonggyecheon began, how policy-makers and urban planners worked together, and what it has accomplished. It is expected to set a new paradigm for urban management in Korea. The restoration of Cheonggyecheon intended to accommodate both the environment and the people who live and work there.

With the restoration of Cheonggyecheon, Seoul regains its status of a six hundred-year-old capital and continuously reworks itself as a place where tradition and future mingle together.

Organized by the City of Seoul.

Sunday, 3 June • 13:00-17:00

Min-Max: 60-80 • \$40 (includes lunch)

B Landfill Sites

Nanjido World Cup Park

Nanjido used to be an ecologically fertile place where diverse birds, flowers, animals, and plants existed. However, right after the City of Seoul started to dump wastes there in 1978, it quickly became a polluted nobody's land. It was sacrificed for the name of industrialization and urbanization. The abandoned land behind the economic growth was plagued by almost 1,400 fires (because of harmful gas) and it wasn't even treated differentially for industrial and non-industrial wastes.

Thus, the City of Seoul began to recognize the devastation of Nanjido and to master-plan how to recover the former status of Nanjido as an environmentally-friendly place. Good quality soil, sand, and hundreds of thousands of tons of water supplied Nanjido and a stream was revived, inviting birds and fish to return.

Nanjido, nowadays, has been ecologically changing thanks to environment reconstruction processes such as leachate, landfill cover soil, and slope stability treatment. The City of Seoul aims to stabilize the place until 2020 and continuously invests millions of dollars to transform the waste-damaged place into an ecologically-friendly one.

Nanjido has expanded into five parks: Pyeongwha, Haneul, Noeul, Nanjicheon, and Hangang Riverside.

Dream Park

Dream Park strived for the model of a waste-management facility that accommodates a pleasant ecological park, high-tech environmental management, and popular recreation.

Usage status by landfill site is:

- 1st landfill site: public gymnasium (maximum users per day: 1,800 persons) and sports park are utilized as a public leisure place and resting space.
- 2nd landfill site: organic matter and nitrogen from leachate are completely treated. The amount of leachate and landfill gas decreased and the amount of landfill waste dropped to 80% of the existing level.
- 3rd landfill site: waste utilization complex, temporary sapling house, and flowering plant complex have been built. Foundation work is under construction. Wind power plant is established on the seaside.
- 4th landfill site: ecological park and sports park have been established near the island. Wind power plant is established on the seaside.

Organized by the City of Seoul.

Monday, 4 June • 09:00-17:00

Min/Max: 30-80 • \$40 (includes lunch)

C Seoul Forest

Seoul Forest is a theme park devoted to building an environment-friendly park in the midst of Seoul. It was built by Seoul citizens who volunteered to plant trees under a "Citizens' Tree Planting."

The Forest measures about 1.155 million square meters in the Tukseom district in Seoul. The foremost aim of the Seoul Forest was to create an ecologically diverse place and to build habitats for wild animals and plants. Built on the spacious 350,000 pyong (=3.954 sq.), it will serve as a pivotal place to provide the gigantic city with oxygen and natural habitats. It is currently divided into five different districts: Cultural Art Park, Ecological Forest, Nature Experiencing Studying Field, Wetlands Ecological Field and Han River Waterside Park.

Organized by the City of Seoul.

Friday, 8 June • 13:30-18:00

Min/Max: 30-80 • \$40 (includes lunch)

D Lake Shihwa

Shihwa was intended to be a place to de-populate and de-industrialize metropolitan Seoul.

To accommodate economic growth on the west coast and ecology, millions of dollars to develop the multi-tech valley, Songsan green city, and an artificial reed wetland has been poured into Shihwa.

Simultaneously, a tidal power plant to develop an alternative energy has been under construction.

With the completion of the tidal power plant and ecological park, Shihwa will be an ideal ecological city that would eventually drain population and industry in Seoul.

Organized by the Korea Water Resources Corporation (K-Water).

Monday, 4 June • 09:00-17:00

Min/Max: 20-80 \$50 (includes lunch)

Sections

ABOUT IAIA SECTIONS

IAIA Sections provide opportunities for IAIA members with mutual interests to share experiences and discuss ideas in an informal setting. Sections provide a forum for active topical debate and for development and promotion of good practice. Sections are in different stages of development: some currently have their own projects, newsletters, and listserv discussion groups. All Sections welcome new members.

See page 11 for meeting time and locations.

Agriculture, Forestry and Fisheries: New in 2005, this Section focuses on finding ways and means of increasing and improving the application of EIA to these sectors based on study, research, and input from practitioners. Section coordinator and listserv facilitator: Patrick Duffy.

Biodiversity & Ecology: Ecological impact assessment, biodiversity in impact assessment, ecological compensation and mitigation, impact assessment for protected area establishment and management. Section coordinators: Asha Rajvanshi and Verina Ingram. Listserv facilitator: Andrea Athanas.

Disasters and Conflicts: Disseminate information on disaster issues and participate in the development of sustainable disaster management strategies. Section coordinators: Charles Kelly and Michel Bouchard.

Environmental Impact Assessment Law, Policies and Practice: Environmental legislation and its vital role in EA policy and practice. A goal of this Section is to develop links with key legal organisations so that IAIA can play a part in the development of environmental legislation which will promote equitable and sustainable development throughout the world. Section coordinator and listserv facilitator: Jan de Mulder.

Environmental Management Systems: Environmental auditing and management. Incorporating auditing and impact assessment into environmental management systems and the development and operation of corporate environmental strategies. Section coordinator: Debra Zanewich. Listserv facilitator: Angela Pinilla Urzola.

Health Impact Assessment: HIA throughout the world, integration of human health concerns into impact assessment, and human health risk assessment. Section coordinator and listserv facilitator: Lea den Broeder.

Indigenous Peoples: Indigenous issues in IA, developing guidelines for the recognition and full inclusion of indigenous concerns in all aspects of impact assessment, traditional knowledge, and impact assessment capacity building for indigenous people. Section coordinator: Bob Tai.

Integrated Assessment of Trade-Related Policies: Promotes publication in IAPA of scholarly and general information on policy development, case studies, methodologies and codes of good practice that enables

practitioners in the developed and developing countries to conduct IAs. Section coordinators: Bernice Goldsmith and Rachel McCormick.

Public Participation: Explore principles and techniques of effective public participation as part of EA. Section coordinator: Pierre Andre.

SEA: All aspects of strategic environmental assessment, development of legislation, and SEA as a tool for cumulative effects assessment, etc. Section coordinator and listserv facilitator: Thomas Fischer.

SIA: The development of professional good practice in all aspects of SIA, drawing on the experience of SIA practitioners in the private, public and academic sectors around the world. Section coordinator: Ilse Aucamp. Listserv facilitator: Frank Vanclay and others.

Students and Early Professionals (SEP) is not a formalized Section, but provides a forum for SEPs to exchange ideas and experiences. It is also intended to provide an opportunity to pursue improved SEP involvement in IAIA throughout the year and at IAIA annual meetings. Listserv facilitator: Tracey Nitz.

Council Meeting

Thursday 7 June • 12:30-13:30 • 402

The IAIA Council serves as an advisory resource to the IAIA Board of Directors. The Council is composed of the Board, all Committee chairs, representatives of affiliates and branches, the CEO and Headquarters representatives, and the Conference Program Chair(s) for the current-year conference and any future known conferences. Council meetings are open meetings; all IAIA members are encouraged to attend.

Committee and Section Meetings

Much of the cutting-edge work of IAIA is the direct result of Committee and Section activity. The only chance for Committees and Sections to meet throughout the year is at the annual conference. Everyone is welcome to attend a Section meeting. See page 32 for a description of the Sections. If you are interested in serving on an IAIA Committee, please indicate your interest on the member information directory form mailed to you when you pay your membership dues, or indicate your interest online in "Manage My Membership."

See page 11 for meeting times and locations.

ABOUT IAIA

The International Association for Impact Assessment was organized in 1980 to bring together researchers, practitioners, and users of various types of impact assessment from all over the world.

IAIA members number over 2,500 and reside in over 100 countries. IAIA activities are carried out locally and regionally through its extensive network of Affiliates and Branches.

IAIA's Vision: IAIA is the leading global authority on best practice in the use of impact assessment for informed decision making regarding policies, programs, plans, and projects.

IAIA's Mission: IAIA provides an international forum for advancing innovation and communication of best practice in all forms of impact assessment to further the development of local, regional, and global capacity in impact assessment.

IAIA's Values: IAIA promotes the application of integrated and participatory approaches to impact assessment, conducted to the highest professional standards.

IAIA believes the assessment of the environmental, social, economic, cultural, and health implications for proposals to be a critical contribution to sound decision-making processes, and to equitable and sustainable development.

Annual General Meeting (AGM)

Wednesday 6 June • 12:30-13:30 • 402

This is the annual business meeting of the Association. All meeting participants are encouraged to attend, learn more about the operation of the organization, and ask questions. (Note: the non-member conference registration rate includes a one-year membership to IAIA.)

2007 AGM Agenda

1. Welcome, introductions, and confirmation of 2006 AGM minutes.
2. IAIA 2006/7: What have we done and where are we going?
3. Money matters.
4. IAIA Presents Excellence: The Capacity Building in Biodiversity and Impact Assessment (CBBIA) Project.
5. Any debate? Items submitted in writing by members.
6. Have your say: Informal discussion of matters that members wish to raise.
7. Closing remarks.

Notes

Tips and Information

How to Get the Most from This Conference

- **Inform, prepare, and orient yourself.** Check in early and then take time to walk through the venue to familiarize yourself with locations of activities before the rush of the conference begins. Read through the program carefully and highlight the sessions you want to attend. Read those abstracts and prepare questions for the speakers.
- **Make a goal sheet.** Why did you decide to register for this program? What is it you expect to gain? Take a moment to think about your goals. Then clarify them by writing them down in your program. Look over your goal page throughout the conference; it will help you keep your goals focused.
- **Meet other people.** This is an excellent opportunity to expand your network of contacts. Sit next to someone you don't know, even if you've come with a group. Mingle during the breaks. Exchange business cards. Every participant here has a specific area of expertise; find out what it is instead of chatting about the weather. Let us suggest that one of your goals be to meet at least one person each day whom you intend to communicate with again on a business or social basis.
- **Participate!** Ask questions. Make contributions. Actively participate in the exercises. Consider the meeting room to be a "mental gym" where it's okay to run, fall, and get up again. You'll benefit much more by participating in the game than sitting on the sidelines.
- **Relate what you learn to yourself.** Don't settle for "abstract" knowledge. Have your current problems, conflicts and interests foremost in your mind. As you learn new approaches and techniques, relate them to your own situation.
- **Make a commitment to review your notes.** Right now, take out your calendar and make a one-hour appointment with yourself in a few weeks to "retake" the program. Don't put your good ideas away with your notes. And consider reviewing your notes each evening during the conference while your ideas and enthusiasm are fresh.
- **Write a "Dear Boss" letter.** If your boss or company sent you to the conference, thank them with a letter. Include a list of your action ideas based on your action plan and goals - what you intend to do or change as a result of what you have learned. If you paid your own way, still send the letter. It will show how committed you are to your own professional growth.
- **Enjoy yourself.** Start relaxed (rest and rehydrate to help recover from jet lag) and you'll leave refreshed, inspired and recharged. Forget about what's happening at the office. This is your conference. Get all you can out of it.

Definition of Terms

- Annual Conference:** An extended collection of IAIA and IAIA-related events within a week to two-week time frame, including special meetings, technical visits, short courses, and social events.
- Annual Meeting:** The core of the annual meeting; typically 3-4 days devoted to plenaries, concurrent sessions, and IAIA business.
- Session:** A block of time during which presentations are made on a single topic.
- Concurrent sessions:** Sessions running in parallel, during which approved papers are presented by authors and discussed by participants.
- Stream:** A number of sessions on the same topic.
- Paper Presentation:** The oral summary of a paper within a session.
- Poster:** Visual presentation of a paper or project by means of graphics, photos, data, and a small amount of text on a display area. Posters are self-explanatory, but poster authors are available to answer questions during the session dedicated to poster viewing.
- Workshop:** The topic is specific and active discussion seeks to resolve a defined problem. May be a combination of paper presentations and discussion.
- Panel:** Invited speakers present different views or experiences on a topic, typically followed by an informal discussion between the speakers and questions from the audience.
- Roundtable:** A group of individuals, usually invited, hold an informal discussion on a specific topic or problem.
- Speed Session:** As many as 10 papers may be presented; each author has 3 minutes maximum to summarize the point of his/her paper. The remainder of the session time is facilitated discussion.
- Theme Forum:** Smaller than plenaries and larger than concurrent sessions, Theme Forums bring together on a particular topic the various aspects of impact assessment and examine how those aspects apply to different sectors and issues. The Theme Forums on the IAIA07 final program were competitively selected by the program committee based on relevance of topic, quality of content, and selection of speakers.
- Practitioners' Forum:** For issues that arise during the conference and that practitioners want to pursue through informal follow-up discussions. During the morning, participants post potential topics for discussion, and individuals interested in each topic sign up for the related discussion. If a topic generates sufficient interest, space is made available for the discussion to take place in the late afternoon.

Greening the Annual Conference

! **Take a close look at the pencils contributed by Remarkable—did you guess that they are made from recycled CD cases?**

Does IAIA practice what it preaches? Yes, and more so every year. IAIA takes the following steps to mitigate the impacts of our conferences:

- Limit printed materials; communicate via e-mail and web to the extent practical and possible
- Contract only with venues that participate in green programs (e.g., hotels that provide a linen and towel reuse program)
- Use bulk servings and pitchers rather than individual bottles
- Use china and silverware rather than disposables
- Provide recycling bins for discarded paper products
- Ask delegates to confirm their attendance at events and functions to reduce waste and leftovers
- Provide evening sustainable dining options
- Encourage delegates to purchase carbon-offset credits for their flights

To the extent possible and practical, IAIA implements these (and other) policies and practices. Delegates are welcome to make additional suggestions on the IAIA07 conference evaluation form (which will be distributed electronically to delegates following the conference) or by contacting IAIA HQ at any time.

General Information

Conference Papers and Proceedings

Abstracts volume: An abstracts volume is included in the delegate packets and is posted on the IAIA web site.

Participants list: A list of pre-registered participants is provided in the delegate packets. A final list of participants will be posted online after the conference.

Proceedings: IAIA will be publishing conference proceedings on CD-ROM following the conference. Preparation of a full paper is optional. For publication on the conference CD-ROM, materials must be submitted electronically. File format: MS WORD or PDF. Do not zip files. There are no other formatting requirements or restrictions on length. E-mail the file as an attachment to impact@iaia.org no later than 1 August 2007. Files received after 1 August will not be acknowledged or included in the proceedings.

The following information must be provided in the Subject line of the e-mail and should also be the name of the Word file:

1) The pound sign (#) followed by your paper or poster abstract number as previously provided to you by IAIA. (The number is available in your confirmation of submission notice, from your abstract reviewer's notice of acceptance, the final program, the abstract volume, online, or from your session chair.)

2) The last name of the presenting author, as originally submitted with the abstract.

3) The full title of the paper or poster.

EXAMPLE: The "Subject" line of your e-mail and the name of the attached Word or PDF file would be #107 *Chan EIA in China*. Submission is automated; e-mails without this subject line format will not be accepted or acknowledged.

Papers will be published as submitted; please edit carefully and include full contact information for authors.

Note to Presenters and Attendees

Discussants and individuals presenting papers should arrive at their sessions 5-10 minutes early to allow time to meet the session chair, prepare presentations, etc. As a courtesy to others in the session, presenters and other attendees are requested to attend all papers in the session.

Presentation Equipment

LCD (PowerPoint) projectors and laptop computers are provided in each concurrent session room. Presenters are responsible for making arrangements in advance with KEI (jylim@kei.re.kr) to reserve and pay on their own for any other equipment needed for their presentations.

Presenters load their own files on the laptops provided; this should take no more than 2 minutes. Preferably, PowerPoint files should be saved to CD-ROM or memory stick. If the file is saved to disk, allow some additional time to change the drive in the laptop from CD-ROM to disk. For security reasons, the session rooms and laptops are not available until the break just prior to the start of the sessions. A preview room (317) is available for testing purposes. Preparation of files on a Mac computer is not recommended; the

venue does not have Apple capabilities. Testing of a Mac presentation on an IBM or HP should have been done prior to arriving at the conference, and Mac presenters must provide their own VGA connectors.

Presenters are solely responsible for any breakdown of equipment they brought with them to COEX. All presenters are strongly advised to test their files, particularly video files, in the preview room (317) to eliminate any malfunction.

Business Services Equipment

Because of high rental costs which would necessarily be passed on to all delegates in the form of higher registration fees, IAIA does not provide copying, printing, computers or other business services on-site. For photocopying or printing, delegates are advised to visit LINKO in the COEX Mall (B1). LINKO daily business hours are 09:00-22:00.

Poster Presenters

Poster panels are set up and assigned to each poster presenter in the Conference Center Lobby on the third floor. You may hang your poster any time between 12:00 - 17:00 on Monday, 4 June. Posters will be on display until 18:00 on Thursday, 7 June, and should be taken down between 18:00-19:00 on Thursday. Please note: IAIA, the conference organizers and the COEX are not responsible for poster materials on display, or posters/cases left after 19:00 on 7 June. You are responsible for providing the materials needed to hold the posters in place. Preparation of a full paper is optional. If you have a full paper related to your poster topic, see the information at left in "Conference Papers and Proceedings." The poster session is scheduled for Tuesday, 5 June, at 12:30.

Booths/Tables

Exhibits/tables are set up and assigned in the Conference Center Lobby. Set up is from 12:00 - 17:00 on Monday, 4 June. Take down is 18:00-19:00 on Thursday, 7 June. Please note: IAIA, the conference organizers and the COEX are not responsible for materials on display, or materials left after 19:00 on 7 June.

Display Table and Book Share

A table is provided in the exhibit area for IAIA members to display information, distribute conference papers, or announce/distribute non-commercial items (leaflets, brochures, books, etc.). The purpose of this table is to enhance the exchange of information. No commercial (sales) materials are permitted. Inappropriate materials are subject to removal. IAIA, the conference organizers, and the COEX are not responsible for items displayed or left after 19:00 on 7 June.

Be sure to visit the book share table as well. Donate a new or recycled book, or take a book if you find one that might not be readily available back home.

Registration and Fees

All conference participants, including delegates, session chairs, invited speakers, organizers, exhibi-

tors and paper and poster presenters, are required to register for the conference at the full, student, or exhibitor registration fee.

Full and student registration fees entitle delegates to attendance at all sessions, coffee breaks, and lunches on Tuesday, Wednesday, and Thursday; opening reception; special conference dinner; banquet; participants list; delegate packet; abstracts volume; conference proceedings; and special events, unless an additional fee is noted.

Payment and Refund Policies

Fees are accepted by cash (US\$, Korean Won), MasterCard, Visa, check, or international money order. Personal checks must be for US\$ drawn on a US bank. Traveler's checks and international money orders must be in US\$.

Registrations after 17 May are accepted on-site only. Official receipts for on-site registration (after 17 May) will be issued by mail after the conference.

No registration will be processed without payment unless arrangements were made with IAIA HQ by 17 May.

IAIA refunds registration fees upon written request received before 31 March. A US\$50 processing fee is retained. After 31 March, no refunds are issued for cancellations or no-shows. Substitutions for paid registrants may be made in writing without penalty. Refunds will be issued after the conference.

Name Badges and Tickets

All conference participants, including speakers and exhibitors, receive a name badge at check-in. The badge is your official pass and must be worn to ensure entry to conference activities.

Tickets required for special events are included in the name tag packet provided at registration.

"Quickpass to the Fastlane"

All conference participants whose registration and fees were received by 31 March 2007 were mailed a purple "Quickpass." Look for purple signs designating the Quickpass registration desk and show your Quickpass for express check-in!

Transportation

Shuttle bus service will be provided between the COEX and conference hotels listed in the program. Timetables will be provided by the hotels.

Hotel/Tour Desk

MECI (the Professional Congress Organizing company) will have a desk in the Jangbogo Lobby for persons wishing to sign up for sightseeing tours or accompanying persons activities or needing hotel or travel assistance.

Hours

15:00-18:30	2 June
08:30-18:30	3-6 June
09:00-12:00	7 June

Conference Evaluation

An evaluation form will be sent electronically to all participants shortly following the conference.

Committees

ABOUT THE HOSTS

The hosts of IAIA07 consist of two Korean organizations: the Korea Environment Institute and the Korean Society of Environmental Impact Assessment.

The **Korea Environment Institute** (KEI) was established to introduce the institution of impact assessment in Korea. After a decade of certain trials and errors, the KEI developed into a solid policy and assessment institute. Every year witnesses numerous seminars, forums, and visits to exchange ideas and improve the quality of impact assessment.

The **Korean Society of Environmental Impact Assessment** (KSEIA) has been actively involved in bringing up rapidly developing ideas and experiences concerning impact assessment. KSEIA has focused on the diverse spectrum of impact assessment from ecological to material aspects.

Coordinating Committee

Suh Sung Yoon (*chair*), KSEIA, Korea
Hoi-Seong Jeong, KEI, Korea
Yoon-hwa Ko, Ministry of Environment, Korea
Jae-Hong Lee, Ministry of Environment, Korea
Yong Chung, Yonsei University, Korea
Sang Wook Han, Kwangwoon University, Korea
Hyouon-Young Lee, Konkuk University, Korea
Sang Hoon Lee, Suwon University, Korea
Myungjin Kim, National Institute of Environmental Research, Korea
Jae Bok Jung, KSEIA, Korea
Insu Lee, KEI, Korea
Wha Jin Han, KEI, Korea
Young-il Song, KEI, Korea
Yoon-young Choi, KEI, Korea
Jaeyoung Lim, KEI, Korea

Public Relations Committee

Soo-jae Lee (*chair*), KEI, Korea
Jong Ho Lee (*co-chair*), Cheongju University, Korea
Young Soo Lee, KEI, Korea
Jun Ho Maeng, KEI, Korea
Dong Jun Chun, KEI, Korea
Juchul Jung, KEI, Korea
Hee Sagong, KEI, Korea
Jong-Ho Kim, KEI, Korea
Paikho Rho, KEI, Korea

Sponsorship Program Committee

Muchoon Lee (*chair*), Yonsei University, Korea
Kwang Kyu Kang (*co-chair*), KEI, Korea
Tae-hwan Ha, KEI, Korea
Tae Ho Ro, KEI, Korea
Joon Hwa Jung, Dae Young EEC, Korea
Sang-hoon Lee, Catholic University of Korea, Korea
Sang Ki Chun, Korea East-West Power Co, Korea

Technical Program Committee

Young Han Kwon (*chair*), KEI, Korea
Heon-Seok Yoo (*co-chair*), KEI, Korea
Jong-Gwan Jung (*co-chair*), Chungnam Development Institute, Korea

Sangbum Lee, KEI, Korea
Young-Joon Lee, KEI, Korea
Jin Hwan Hwang, KEI, Korea
Jeongim Park, KEI, Korea
So Eun Ahn, KEI, Korea
Jung Jae Park, KEI, Korea
Kong-jang Cho, KEI, Korea
Hyosung Sun, KEI, Korea
Sang-Don Lee, Ewha Womans University, Korea
Seok-soon Park, Ewha Womans University, Korea
Dong-kun Lee, Seoul National University, Korea

Special Thanks To

John Glasson, Oxford Institute for Sustainable Development, UK
Rob Verheem, The Netherlands Commission for Environmental Assessment, The Netherlands
Barry Sadler, Consultant, Canada
Maria Partidario, Instituto Superior Técnico, Portugal
Thomas Fischer, University of Liverpool, UK
Maya Villaluz, World Bank, Philippines
Rabel Burdge, Western Washington University, USA
Maria Neira, World Health Organization, Switzerland
Stephen Lintner, World Bank, USA

Technical Program Advisory Committee

Pierre André, Université de Montréal, Canada
Ilse Aucamp, PTERSA Environmental Management Consultants, South Africa
Martin Bjeregaard, Golder Associates, UK
Robert Bos, World Health Organization, Switzerland
Michel Bouchard, Centre International des Technologies de l'Environnement de Tunis, Tunisia
Ben Cave, Ben Cave Associates, United Kingdom
Jaeyoung Choi, Chungnam National University, Korea
Kyungho Choi, Seoul National University, Korea
Jan de Mulder, Public Governance Department, Belgium
Bert Enserink, Techniek, Bestuur en Management, Netherlands
Weston A. Fisher, The Cadmus Group, USA

Peter Furu, Bilharziasis Laboratory (DBL), Denmark
Clive George, University of Manchester, UK
Bernice Goldsmith, Concordia University, Canada
Sachihiko Harashina, Tokyo Institute of Technology, Japan
Ben Harris-Roxas, CHETRE, Australia
Kii Hayashi, Nagoya University, Japan
Verina Ingram, Iwaco, Netherlands
Eunjeong Kang, Korea Institute for Health and Social Affairs, Korea
Charles Kelly, Consultant, USA
Eun-Shik Kim, Kookmin University, Korea
Joon Hyun Kim, Kangwon National University, Korea
Ke-chung Kim, Pennsylvania State University, USA
Bhon K. Koo, Hydro Core, Korea
Jae-hyup Lee, Kyonghee University, Korea
Kyoo-Seock Lee, Sungkyunkwan University, Korea
Myung-Woo Lee, Chonbuk National University, Korea
Sang Eun Lee, Ajou University, Korea
Seokho Lee, Paldang Committee, Korea
Suk Jo Lee, National Institute of Environmental Research, Korea
Marco Martuzzi, World Health Organization
Rachel McCormick, Department of Foreign Affairs and International Trade, Canada
Mikiyasu Nakayama, University of Tokyo, Japan
Suphakij Nuntavorakarn, Health System Research Institute, Thailand
Angela Pinilla Urzola, International Centre for Corporate Social Responsibility, UK
Asha Rajvanshi, Wildlife Institute of India, India
Deok-Gil Rhee, Kumoh National Institute of Technology, Korea
Jeong-Jeon Rhee, Seoul National University, Korea
Bobbi Schijf, Netherlands Commission for EIA, Netherlands
Dongwon Shin, Ministry of Environment, Korea
Jung-Sup Um, Kyungpook National University, Korea
Frank Vanclay, University of Tasmania, Australia
Petrie Van Gent, Netherlands Commission for EIA, Netherlands
Annica Waleij, Swedish Defense Research Agency, Sweden
Lee Wilson, Lee Wilson & Associates, USA
Grant Wroe-Street, UNEP, Post-Conflict Branch, Switzerland
Jae-Seok Yun, Kukmin Daily, Korea
Debra Zanewich, Export Development Canada, Canada
Yun Zhou, International Cooperation Department, China

Maps: COEX Convention Center

FLOOR PLAN | 1st floor

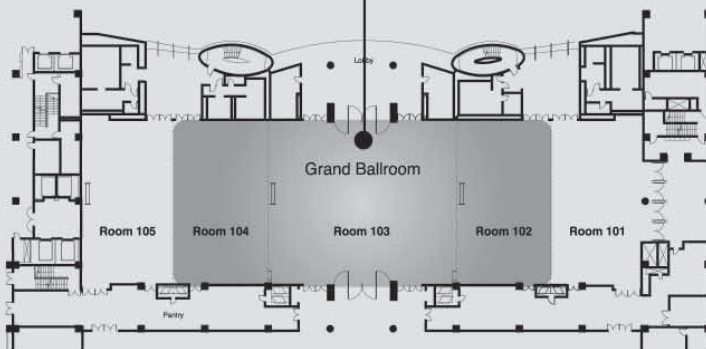
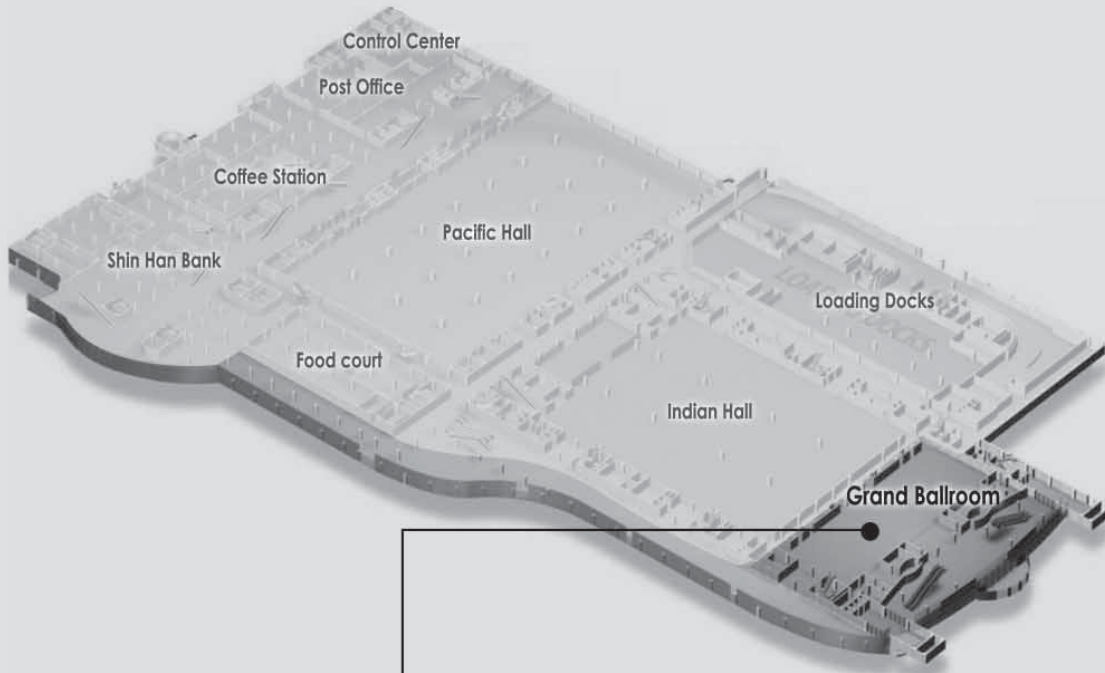

Grand Ballroom

- 102-104 Opening Reception
Opening Plenary
Conference Banquet
Award and Closing Ceremony

IAIA 07

Map: COEX

FLOOR PLAN | 3rd floor

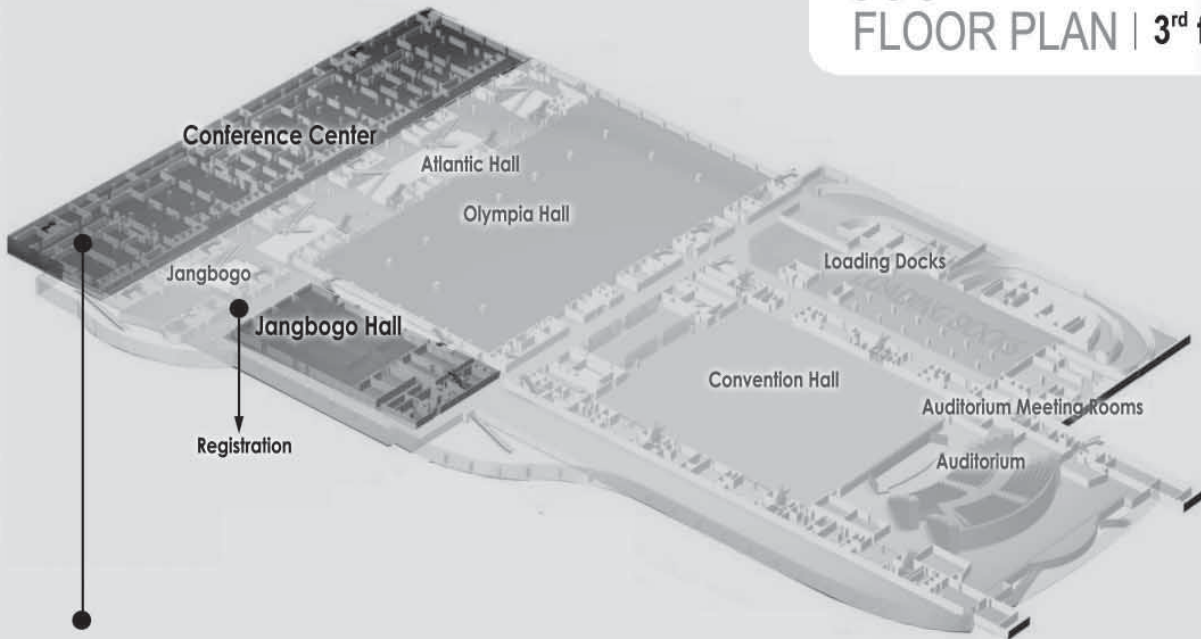

Conference Center

- 314 Secretariat
- 317 Preview Room
- 318 Internet Café
- Lobby Poster Display / Table Display
- Exhibition
- Coffee Break
- Jangbogo Hall Free Function Registration/ Tour/ Hotel/ Info
- 310 DMZ Workshop
- 311 HIA Workshop
- 322/ 323/ 324/ 325/ 326/ 327/ 329 Training Course
- 304/ 307/ 308/ 310/ 311/ 320/ 321/ 323/ 330 Concurrent Sessions
- 310/ 311/ 320 Theme Forums

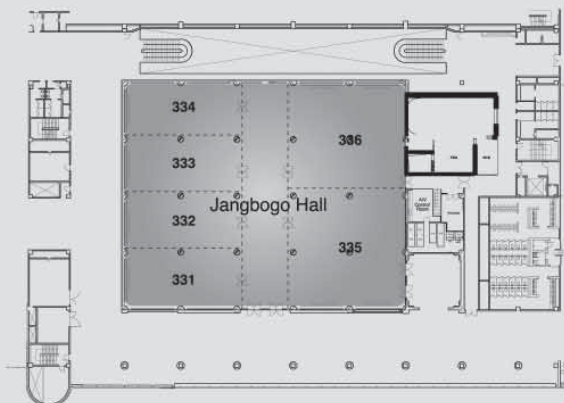

Jangbogo Hall

- 331-336 Special Dinner Lunch

IAIA 07

Map: COEX

FLOOR PLAN | 4th floor

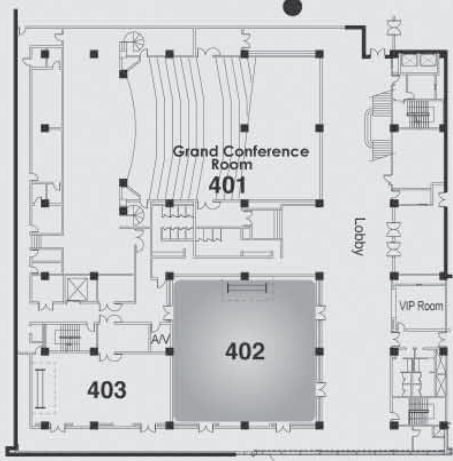
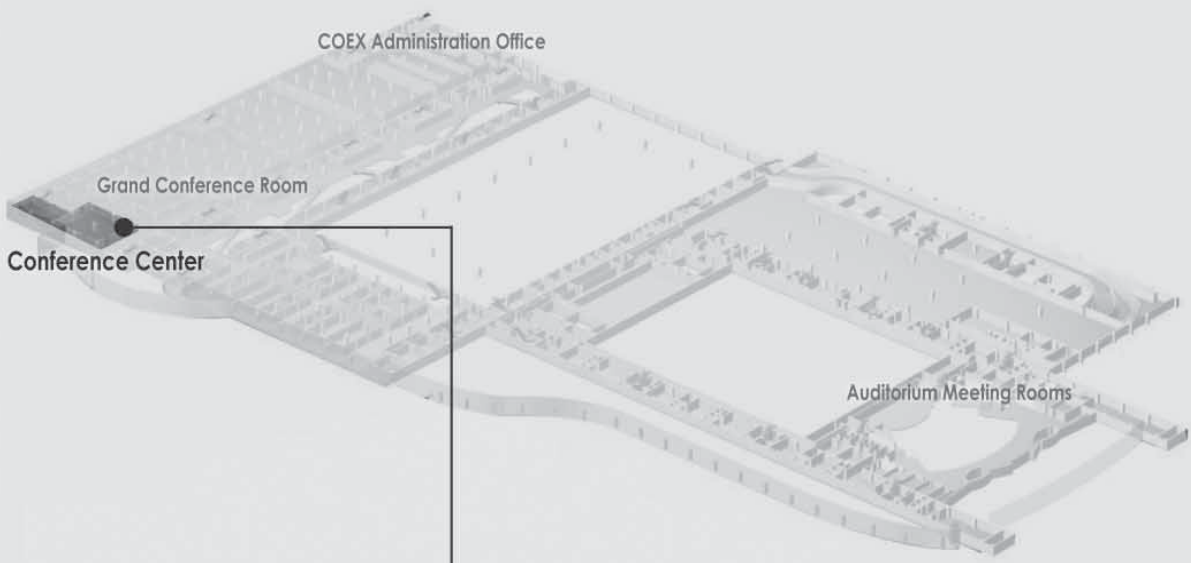

Conference Center
• 402 AGM
Council Meeting

IAIA 07

Earth Sponsors



Continent Sponsors



Seoul Metropolitan
Government



THE FEDERATION OF KOREAN INDUSTRIES



Samsung Corporation

Island Sponsors



Government
of Canada

Gouvernement
du Canada



Korea Tourism Organization

Reef Sponsors

**Environmental Training
& Consulting International**

Ramboll Natura

Remarkable Pencils, Ltd.

Special Thanks

IAIA gratefully acknowledges these companies and organizations for their generous financial and in-kind support of IAIA07.

By sharing their resources, these companies and organizations demonstrate their commitment to the environment and contribute to the improvement of impact assessment around the globe.

When you meet a representative of one of these organizations, at the conference or in the months ahead, please be sure to thank them for their contribution.



**International Association for
Impact Assessment**

International Headquarters

1330 23rd Street South, Suite C

Fargo, ND 58103-3705 USA

Phone +1.701.297.7908 • Fax +1.701.297.7917

info@iaia.org • www.iaia.org